

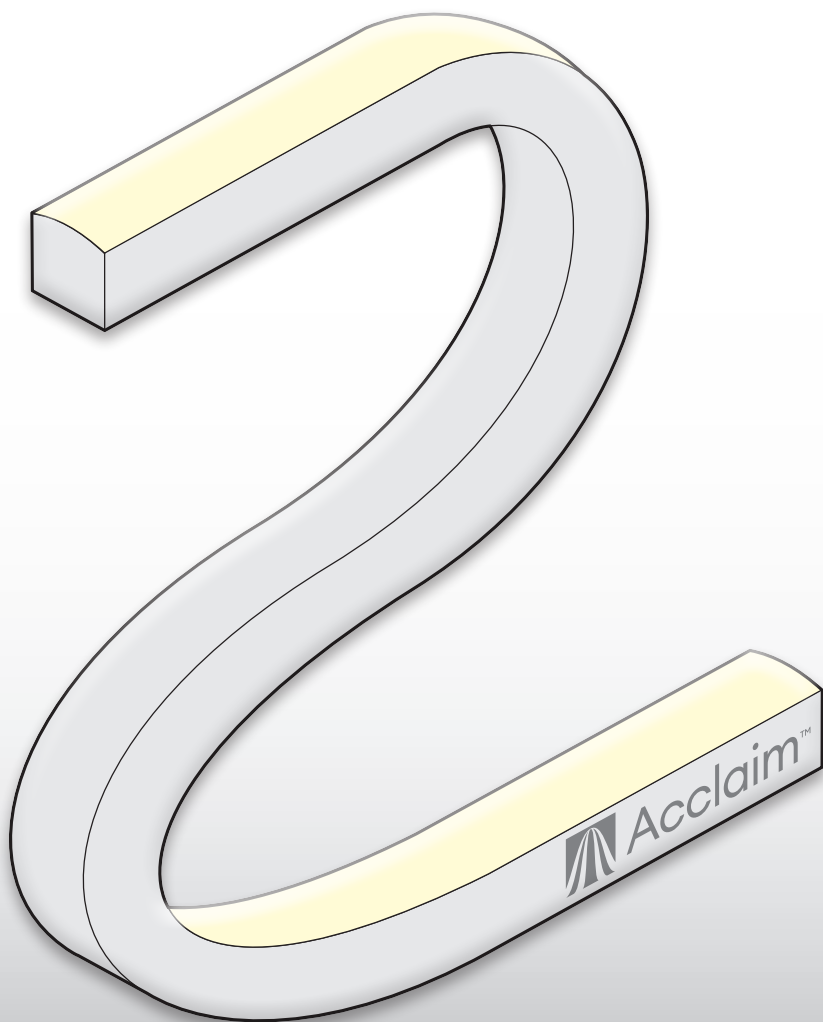

Acclaim™



**Flex Tube Mini™**

User guide



# Contents

<b>Introduction.....</b>	<b>2</b>
Welcome	2
Safety, maintenance and cleaning	2
Bends, feeds and colors	3
<b>Installation.....</b>	<b>4</b>
Take great care to avoid damage during installation	4
Two person install	4
Unpacking	5
Bending Flex Tubes	6
Cable care	7
Avoid aligning with expansion joints	8
Leave room for expansion	9
Mounting channel kits	10
Connecting and controlling Flex Tubes	12
APS-300-24-IP (non-dim)	12
AL Driver 1 (single channel dimming)	13
AL Driver 200/400/800 (multi-channel dimming)	14
<b>Further information.....</b>	<b>15</b>
Troubleshooting	15
Specifications	16
Flex Tube Mini dimensions	17
Mounting channel dimensions	18
Limited product warranty	19

# Introduction

## Welcome

Welcome to the Flex Tube Mini from Acclaim Lighting. These compact and flexible LED powered strips produce a greatly homogenized light output along their full length to provide a viable alternative to other linear light sources, such as neon or cold cathode. Designed from the outset for external applications, Flex Tube Mini strips are rated to IP67 and are built to order, in lengths ranging from 3.28" (83.34mm) to 49.2' (15m).

In addition to the length, models are categorized by three core options:

- The axis in which the tube can be curved,
- The direction of entry for the power feed, and
- The color of the LED emitters:
  - ◊ White: 2200K, 2700K, 3000K, 3500K, 4000K or 5700K
  - ◊ Red
  - ◊ Green
  - ◊ Blue
  - ◊ Amber

Please see page 3 for option details.

A range of dimming driver and static power supply options are available from Acclaim Lighting. See the section "Connecting and controlling Flex Tubes" on page 12 and also [www.acclaimlighting.com](http://www.acclaimlighting.com) for further details.

## Safety

- When fixtures are mounted off-ground, ensure they are securely fitted to an appropriate mounting surface.
- Ensure that the power input is supplied from a correctly fused, earthed and environmentally protected location.

## Maintenance

**CAUTION:** *Always isolate mains power before starting maintenance operations.*

- Ensure that all mounting (and device) screws/bolts are fully tight and free of corrosion.
- Ensure there is no deformation to the housing, lenses or fixing points.
- Check that all power supply cables are free from physical damage or material fatigue.
- Use only genuine spare parts supplied by Acclaim Lighting.

## Cleaning

- Use a moist, lint-free cloth when cleaning each fixture.
- Never use alcohol or solvents.

### Bends, feeds and colors

Flex Tube Mini strips are available with two bend options, four choices of power feed and ten LED emitter colors, which can be mixed in any combination to suit your installation.

The overall order code is arranged as follows:

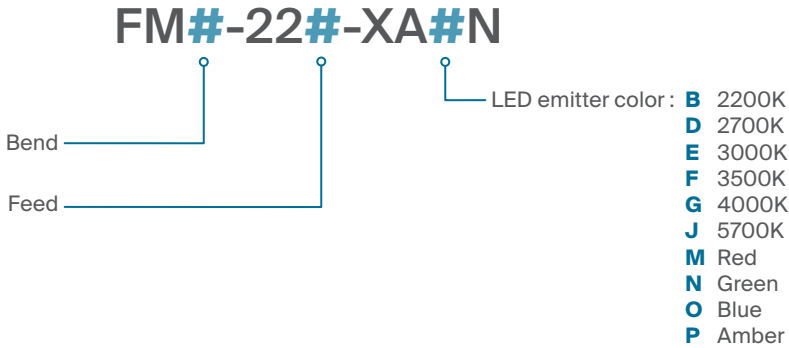

The bend and feed options affect the order code as follows:

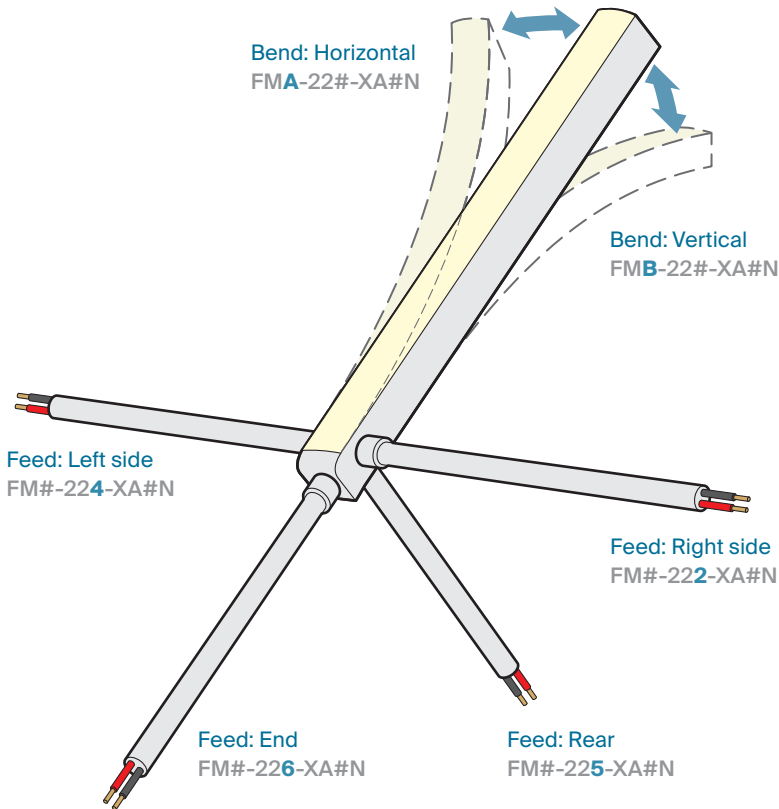

# Installation

## Take great care to avoid damage during installation

Flex Tubes will provide many years of reliable service, however, they contain delicate components which are prone to damage if handled incorrectly or treated roughly. Please read and follow all of the directions given on these four pages before attempting to install any Flex Tube:

- **Two person install** - see below.
- **Unpacking** - see page 5.
- **Bending Flex Tubes** - see page 6.
- **Cable care** - see page 7.
- **Avoid aligning with expansion joints** - see page 8.
- **Leave room for expansion** - see page 9.

## Two person install

- Installation requires two people in order to prevent potentially damaging bends or kinks.

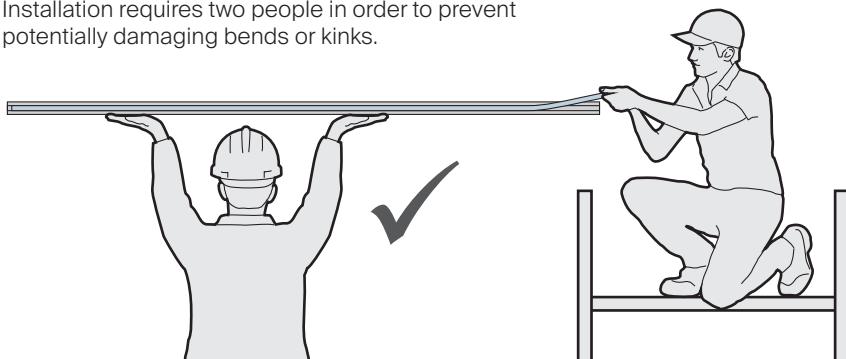

- Do not attempt to install Flex Tube into the mount channel alone or allow the Flex Tube to bend in the opposite plane from the intended vertical or horizontal curve (model dependent).

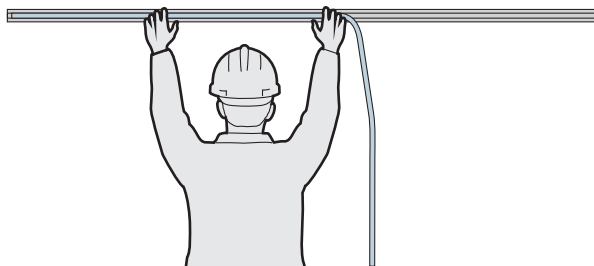

## Unpacking

**CAUTION:** Each Flex Tube Mini contains a delicate LED emitter tape which is designed to bend in one plane only (model dependent). Always take great care to avoid twists and kinks or bends in the opposite plane from the intended vertical or horizontal curvature. Damage can be caused by incorrect handling, resulting in a failed product.

- When unpacking from the supplied box, always extract the Flex Tube Mini by carefully pulling it out through the intended box opening:

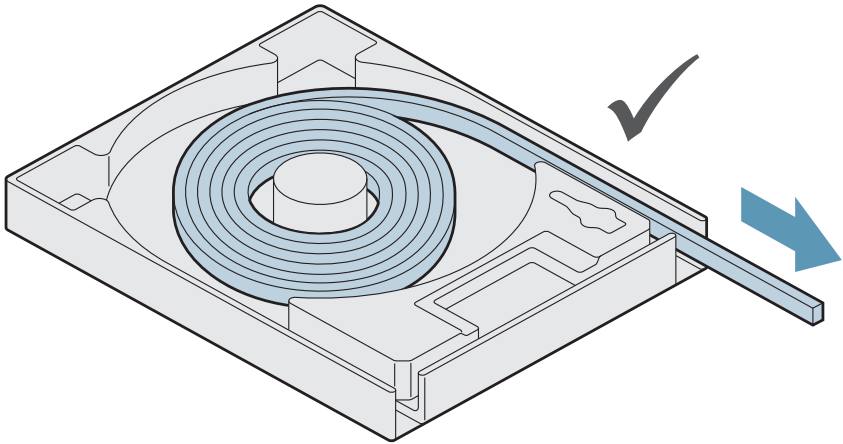

- Never pull the Flex Tube Mini up from the coil:

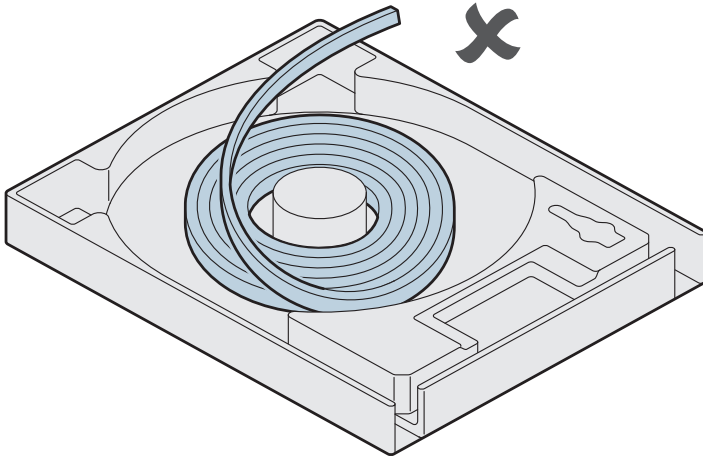

- Keep the Flex Tube Mini as straight as possible prior to installing into the mount channel.
- Never bend the Flex Tube Mini more than 15° from straight (in the opposite plane from the intended vertical or horizontal curve - model dependent).
- Installation requires two people in order to prevent potentially damaging bends or kinks. See “Two person install” opposite.

## Bending Flex Tubes

Flex Tubes are designed to be bent in one axis only  
- to a minimum bend radius of 3.93" (100mm);

### Important

Do not twist; or bend in the wrong direction. Damage will be caused to the internal circuitry.

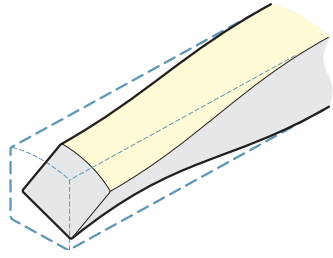

### FMA models

Horizontal bend only

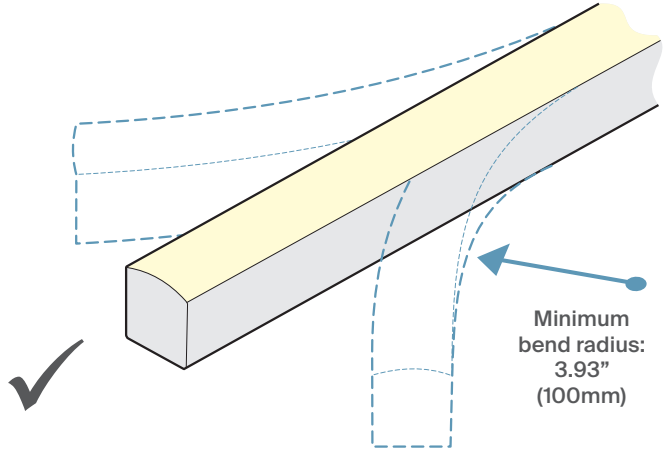

### FMB models

Vertical bend only

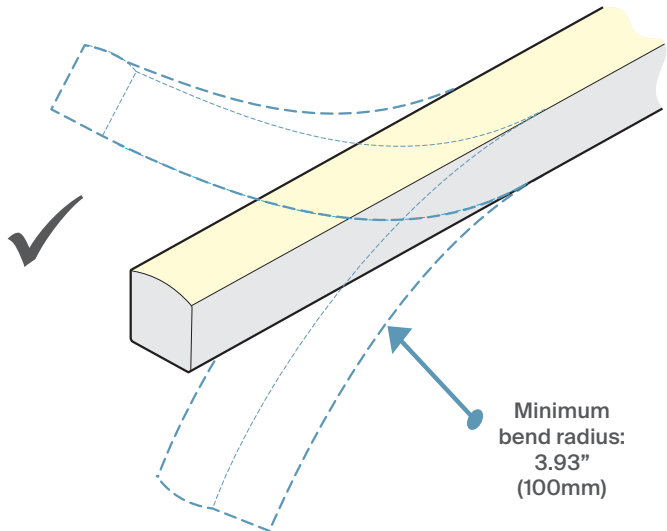



## Cable care

Treat the Flex Tube feed cable with care to avoid damage. Please pay particular attention where the cable enters the body of the tube. Failure to do so may break crucial connections and/or damage the waterproof seal.

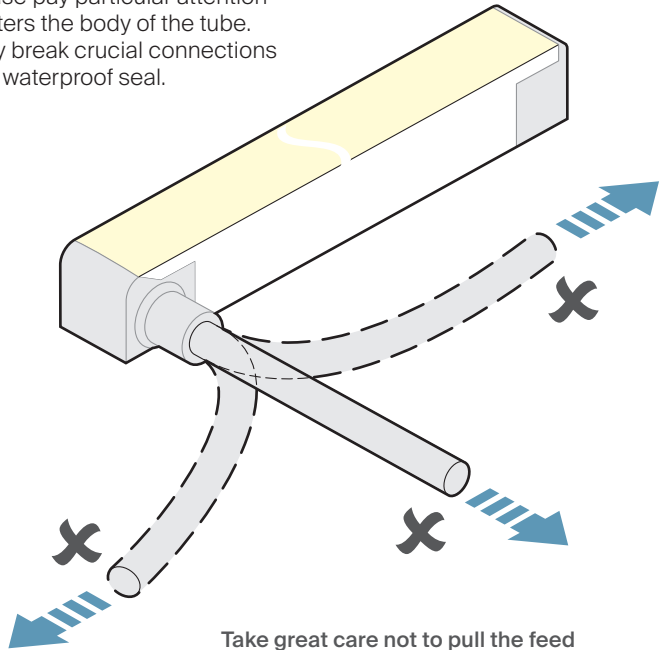

Take great care not to pull the feed cable outward from the tube or bend it sharply in any direction.

Do not subject the feed cable to a bend radius less than 1.57" (40mm) anywhere along its length.

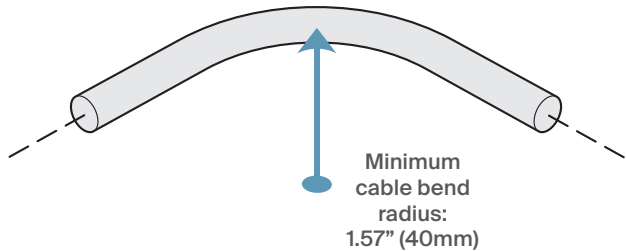

Minimum  
cable bend  
radius:  
1.57" (40mm)

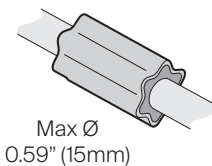

Max Ø  
0.59" (15mm)

*Note: Each feed cable has a metal-encased joint roughly 5" (130mm) from the inlet, which must not be removed.*

### Avoid aligning with expansion joints

If a mounting surface has expansion joints (such as seams between building blocks), ensure that none of the joints between successive Flex Tube channels align near any of the expansion joints. This will avoid placing potential stress points on the Flex Tube within the channel at the join locations.

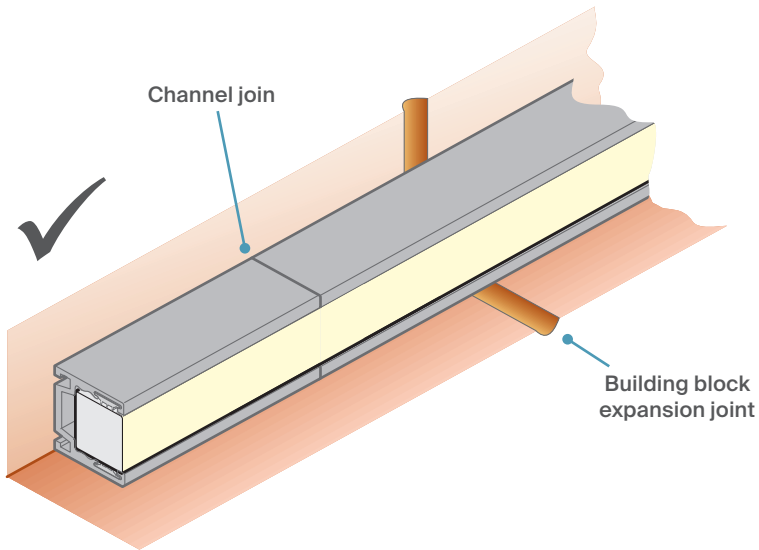
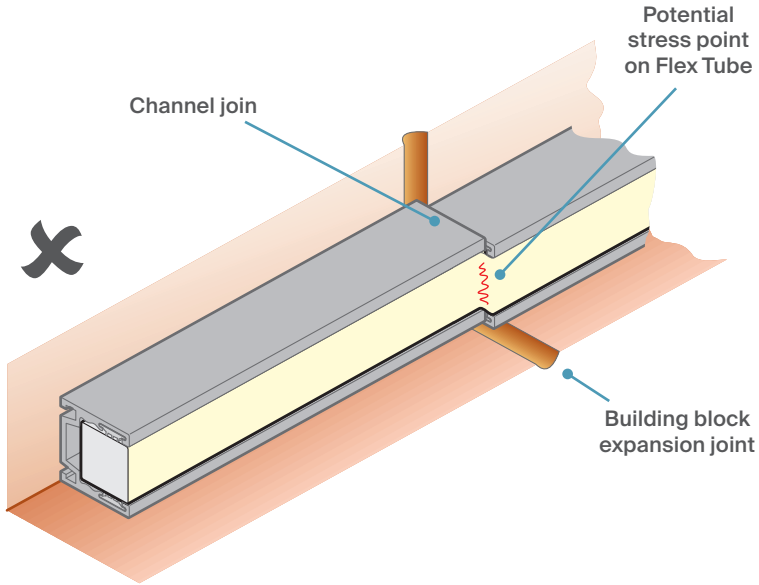

## Leave room for expansion

When placing channels in-ground, leave an extra margin (over the stated channel width) to allow for the slight expansion of the channel once the Flex Tube is positioned in place. An additional 1/16" (1.5mm) should help ensure the Flex Tube is easy to fit and is not squeezed once it is in place.

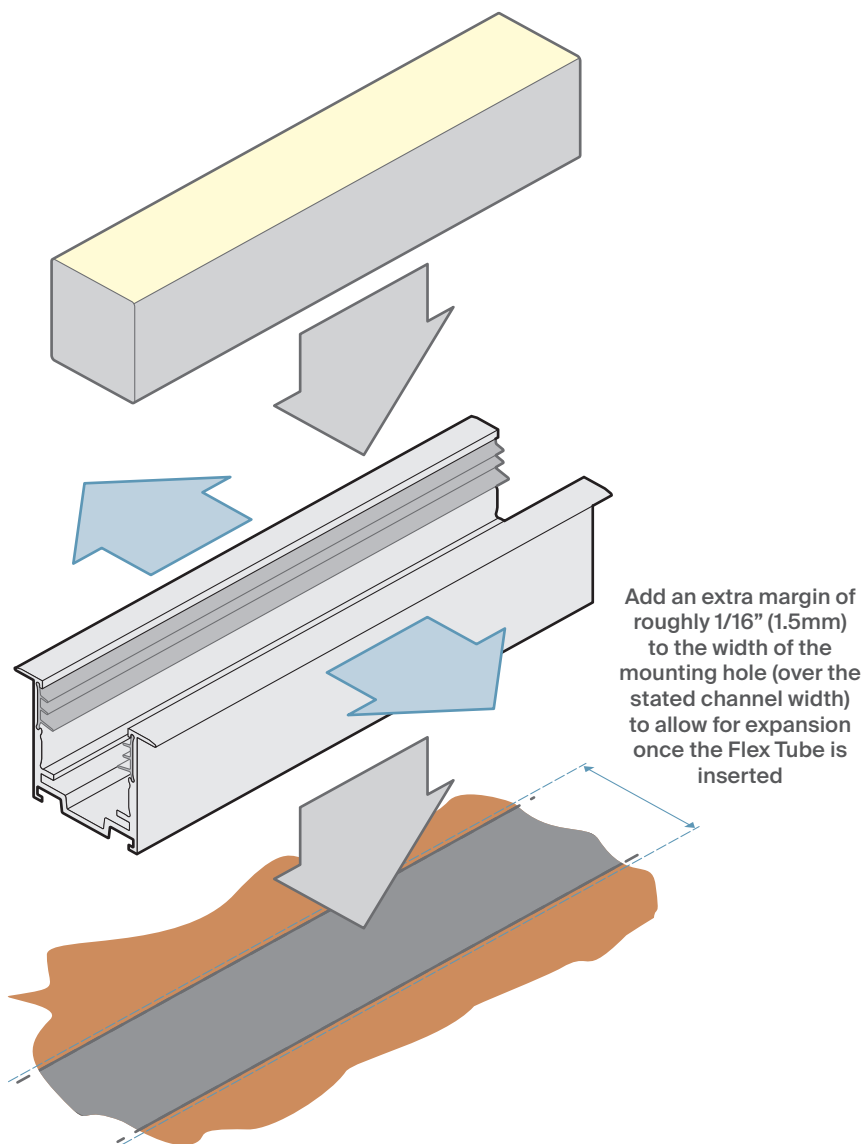

## Mounting channel kits

These kits are used to mount Flex Tube Mini strips onto/into solid surfaces.

### Kit contents

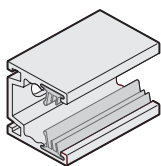

Mounting channel  
(0.79"/20mm, 3.28'/1m  
or 6.56'/2m lengths)

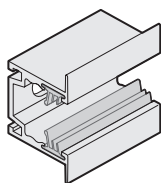

Recessed mounting  
channel (0.79"/20mm,  
3.28'/1m or 6.56'/2m  
lengths)



Self-tapping  
mount screw(s)  
x1, 5 or 10  
(depending on  
channel length)

See "Mounting  
channel  
dimensions" on  
page 18

### To use a mounting channel kit

- 1 Use appropriate screws and fixings for the intended mounting surface.

Each channel is supplied with an appropriate number of countersunk self-tapping screws; these (M3.5 x 25) screws are best suited to mounting on wooden or metal plate surfaces. The supplied screw(s) may also be suitable for other surfaces in combination with wall plugs.

If you need to source alternative screws, be aware that the limited space within the mount channel restricts the screws used to the following dimensions:

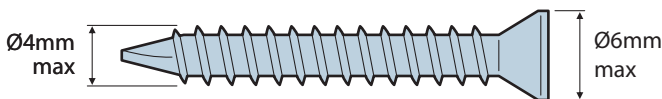

- 2 Attach the mount channel to the intended surface, taking all appropriate precautions as you do so.

- 0.79" (20mm) mounts have one slotted hole,
- 3.28' (1 meter) mounts have five slotted holes, spaced 7.87" (200mm) apart,
- 6.56' (2 meter) mounts have ten slotted holes, spaced 7.87" (200mm) apart.

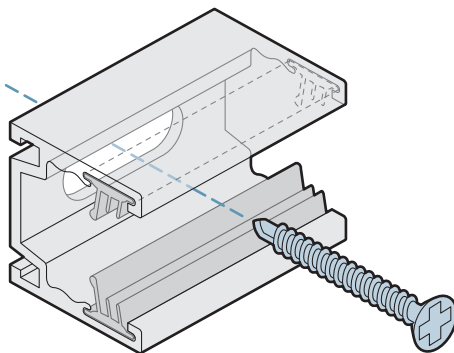

*continued*

- 3 Push the Flex Tube Mini (front face outwards) fully into the mount channel until it engages with the silicone seals.

*Note: To further aid long term stability - If mounting inverted or vertically, we recommend that you add dots of silicone sealant (Dow Corning® 799, 1199 or equivalent) at regular intervals between the sides of the Flex Tube Mini and the inside faces of the mounting channel as it is pushed into place.*

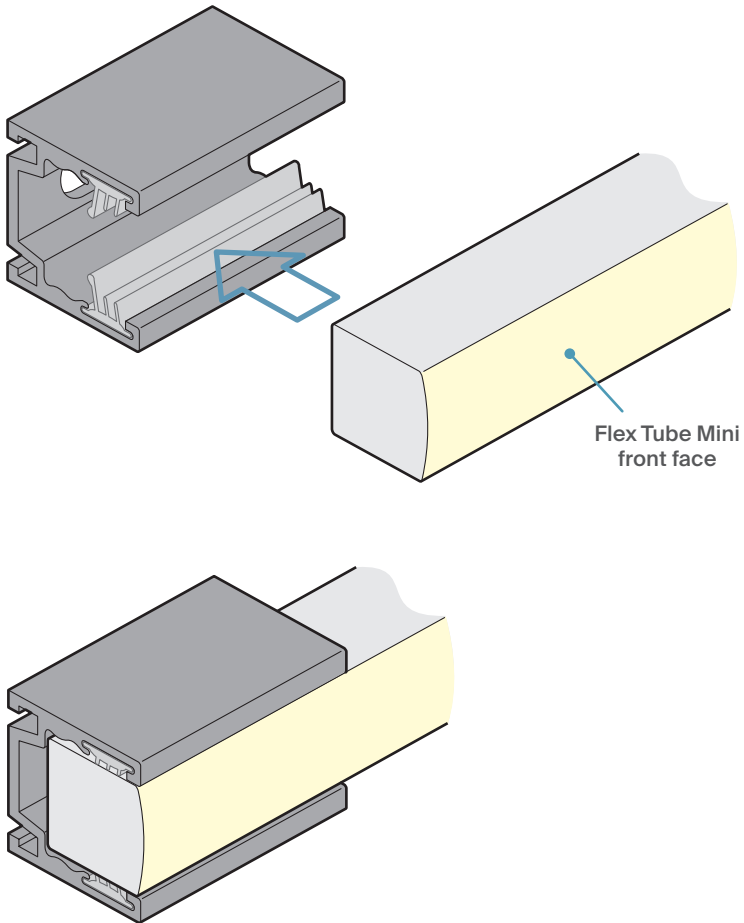

- If you should need to remove the Flex Tube Mini, gently pull it out from the mount channel, taking care not to twist the strip.

## Connecting and controlling Flex Tubes

Flex Tube Mini strips operate at 24VDC and consume 1.37W per foot (or 4.5W per meter). Each strip is supplied with an injection molded 16.4' (5m) feed cable with bare tails.

Connection cables (not supplied) used to link Flex Tubes to the power/driver unit should follow these guidelines:

- Up to 40 feet (12m) 18 AWG (0.823mm<sup>2</sup>)
- Up to 100 feet (30.5m) 14 AWG (2.081mm<sup>2</sup>)
- Up to 180 feet (55m) 12 AWG (3.309mm<sup>2</sup>)

In all cases, ensure that the voltage drop at the fixture end of the link cable is no greater than 8% (1.92V) of the original 24VDC supply.

### APS-300-24-IP (non-dim)

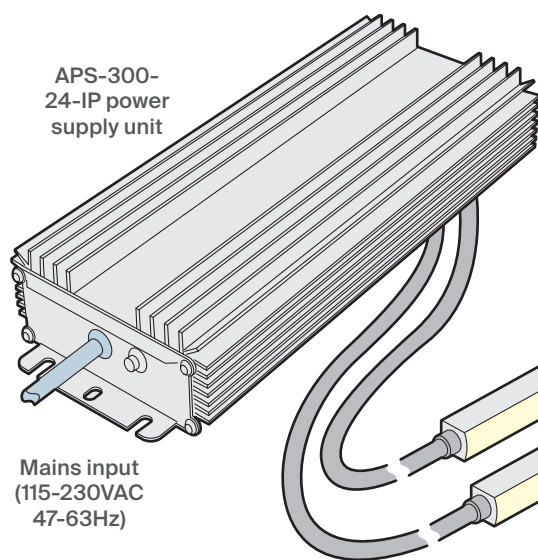

Up to four 15 meter Flex Tube Mini strips can be run from a single APS-300-24-IP power supply unit.

Link cables require 2 cores. See AWG recommendations above.

### AL Driver 1 (single channel dimming - DMX/0-10V)

The AL Driver 1 module controls one circuit of Flex Tube Mini, either under control of an external DMX digital signal, an external 0-10V/1-10V analog signal or using standalone intensity mixes. The AL Driver 1 is a constant voltage device and needs to operate from a 24VDC power supply (5A maximum).

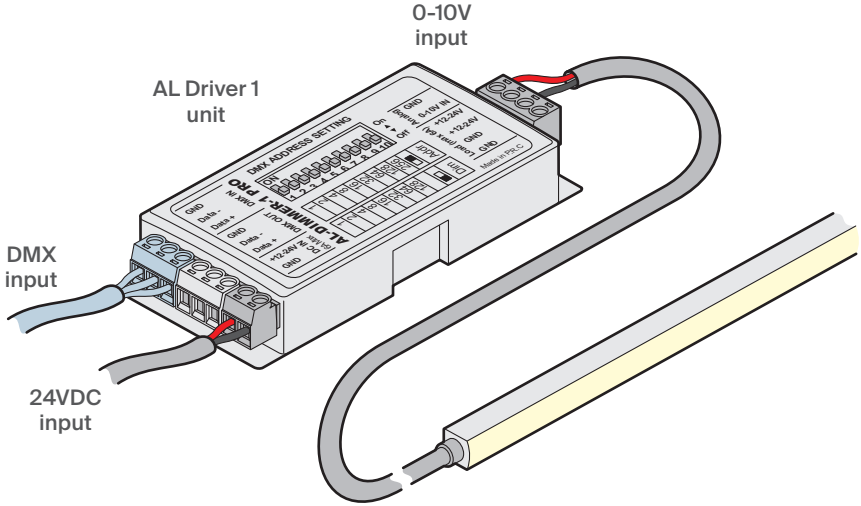

### External dimming control

To select external control, ensure that switch 10 is ON.  
*Note: The DMX and analog (0-10V/1-10V) inputs are both active in this mode, so it is important that only one set of inputs are connected at any one time: either DMX **OR** analog.* When DMX is used, switches 1 to 9 are then used to set the DMX start address. Switches 1 to 9 are 'weighted' with a value as shown here:

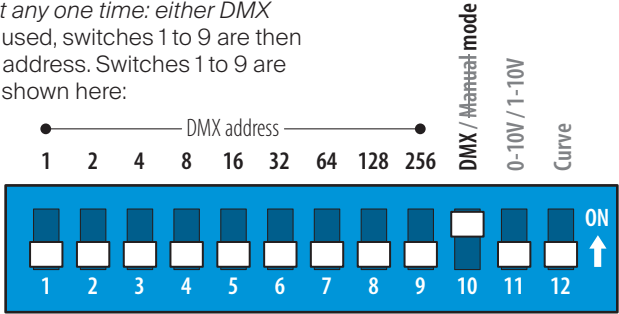

*Note: Numerous apps are available to assist you with configuring the correct switch combinations for a given DMX address.*

### 0-10V / 1-10V selection

Using switch 11, you can choose between 0-10V current source (active) [sw11-OFF] or 1-10V current sink (passive) [sw11-ON] control inputs. The primary difference between the two schemes lies with where the control voltage should be generated: **Current source** requires the controlling device to provide (source) the control voltage; whereas **Current sink** mandates that the controlled fixture must provide the voltage.

### Optional curve smoothing

When switch 12 is set to ON, additional intermediate steps are added to the response curve to help eradicate any visible stepping between the usual 256 (8-bit) dimming levels.

## AL Driver 200/400/800 (multi-channel dimming - DMX/0-10V/DALI)

The full size AL Drivers provide multi-channel dimming control for Flex Tube Mini strips. All three models are connected and configured in similar ways; it is the number of ports and total overall current capacity that changes:

- AL Driver 200 Four dimming ports
- AL Driver 400 Six dimming ports
- AL Driver 800 Ten dimming ports

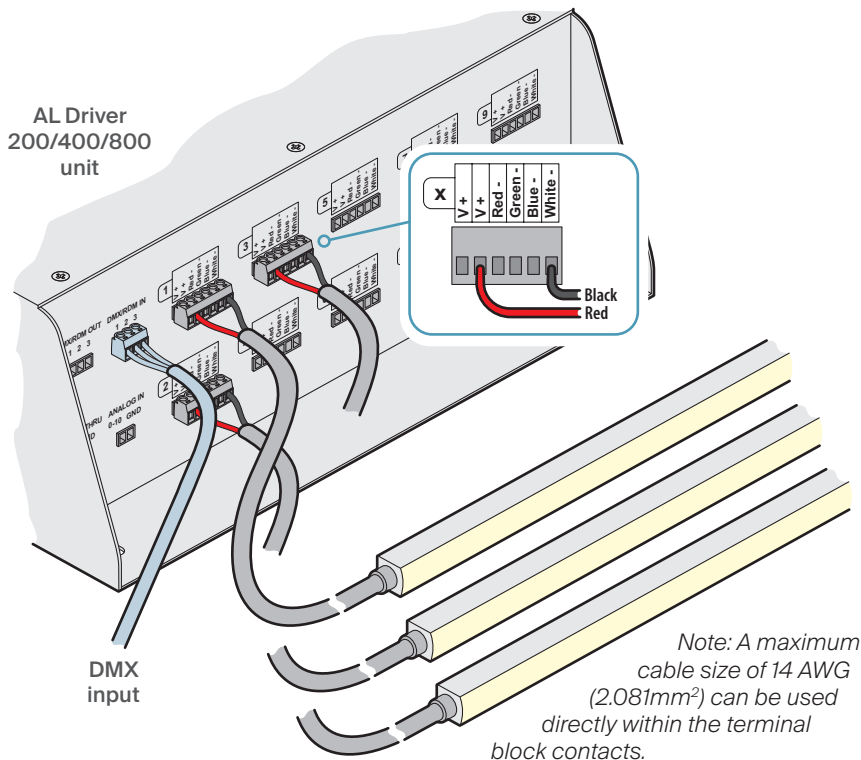

Each port can support a maximum of **6.6A**, which equates to two Flex Tube Mini (49'/15m) strips per channel. However, the maximum overall load across all ports must not exceed the following:

- AL Driver 200 **8A** Equates to a total of 2.8 Flex Tube Mini (49'/15m) strips
- AL Driver 400 **16.5A** Equates to a total of 5.8 Flex Tube Mini (49'/15m) strips
- AL Driver 800 **33A** Equates to a total of 11.7 Flex Tube Mini (49'/15m) strips



# Further information

## Troubleshooting

### No light output is visible when expected.

- Check that power is correctly applied to the fixture and that there is no damage to the power input cord.
- Check that the connections to the feed cable have the correct polarity.
- Check that the DMX address set within the driver module matches that being output by the controlling source device.

Specifications

Colors	2200K, 2700K, 3000K, 3500K, 4000K 5700K, Red, Green, Blue or Amber
Beam angle	120°
Lumens per foot	42 lm/ft ( <i>estimated, testing in progress</i> )
Maximum overall length	Built to order lengths from 3.28" (83mm) to 49' (15m)
Operating voltage	24VDC
Power consumption	1.37W per foot 4.5W per meter 67.5W per 49' (15m)
Lumen maintenance (L <sub>70</sub> )	150,000 hours
Dimming	Pulse Width Modulation
Amb. operating temperature	-40°F to 131°F -40°C to 55°C
Housing	White, silicone
Ingress protection	IP67 wet location
Impact resistance	IK08 Protected up to a 5 Joule impact
Weight	4.3 lbs (1.95 kg) - 15m spool
Certifications	

Flex Tube Mini dimensions

Rear feed  
FM#-225-XA#N

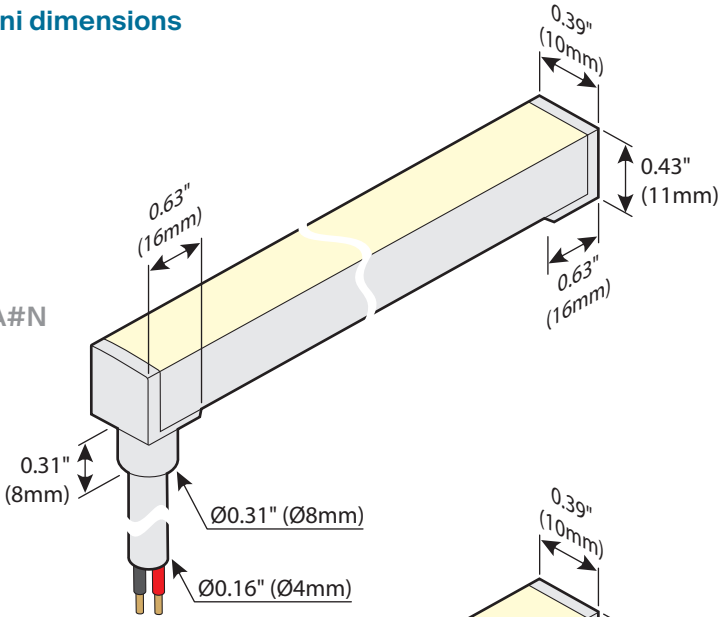

End feed  
FM#-226-XA#N

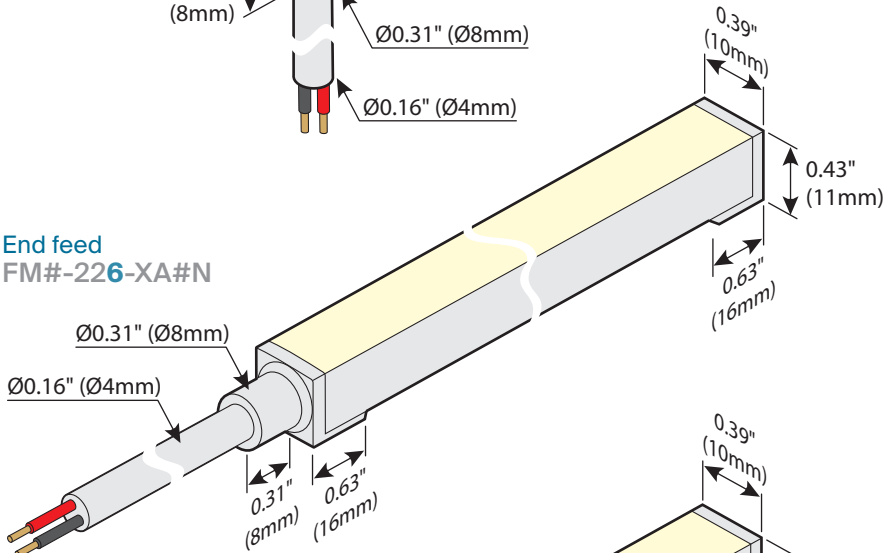

Left side feed  
FM#-224-XA#N

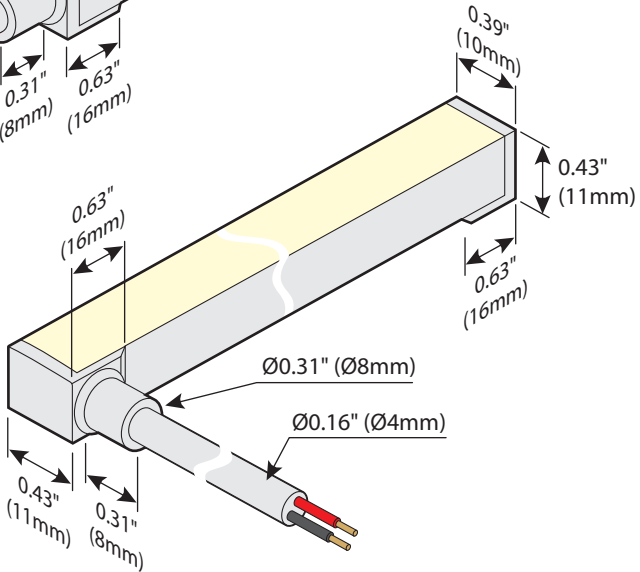

Right side feed  
FM#-222-XA#N

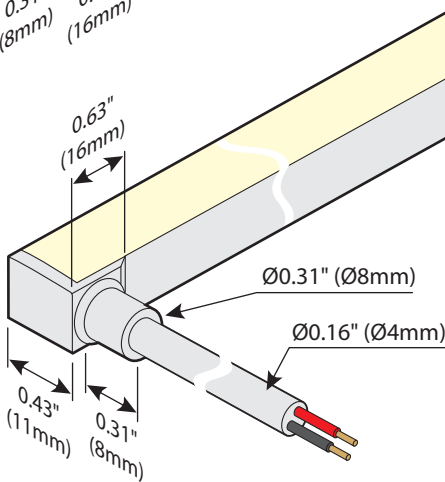

# Mounting channel dimensions

## Surface mounting channel

- 20mm (0.78") FMCH20
- 1m (3.28') FMCH1000
- 2m (6.56') FMCH2000

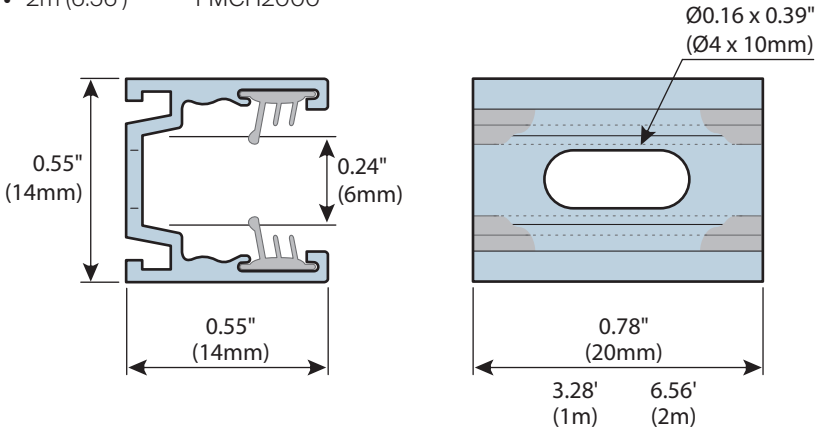

## Recessed mounting channel

- 20mm (0.78") FMRCH20
- 1m (3.28') FMRCH1000
- 2m (6.56') FMRCH2000

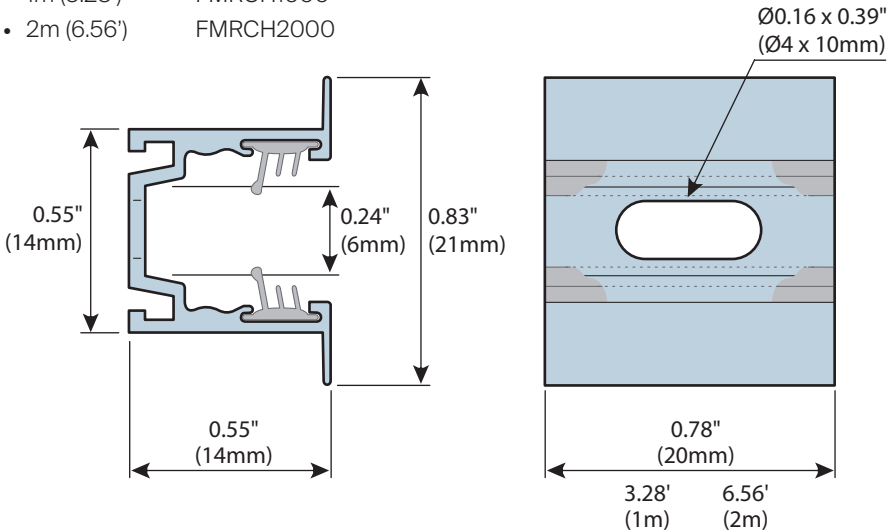

## Slot spacing

On 1m and 2m lengths of both channel types, the screw slots are spaced at 200mm (7.87") centers (five slots on 1m lengths and ten slots on 2m lengths).

## Limited product warranty

A. Acclaim Lighting™ hereby warrants, to the original purchaser, Acclaim Lighting finished products to be free of manufacturing defects in material and workmanship for a standard period of:

- Fixtures: 5 Years (1,825 days) from the date of purchase.
- Drivers, power supplies and accessories: 5 Years (1,825 days) from the date of purchase.
- Flex Products: 3 Years (1,095 days) from the date of purchase.
- Controllers: 2 Years (730 days) from the date of purchase.

It is the owner's responsibility to establish the date and place of purchase and warranty terms by acceptable evidence, at the time service is sought.

B. For warranty service, send the product only to the Acclaim factory. All shipping charges must be pre-paid. If the requested repairs or service (including parts replacement) are within the terms of this warranty, Acclaim Lighting will pay return shipping charges only to a designated point within the United States. If the entire instrument is sent, it must be shipped in its original package. No accessories should be shipped with the product. If any accessories are shipped with the product, Acclaim Lighting shall have no liability whatsoever for loss of or damage to any such accessories, nor for the safe return thereof. Acclaim reserves the right to replace the item with same or similar product at its discretion.

C. This warranty is void if the serial number has been altered or removed; if the product is modified in any manner which Acclaim concludes, after inspection, affects the reliability of the product; if the product has been repaired or serviced by anyone other than the Acclaim Lighting factory unless prior written authorization was issued to purchaser by Acclaim Lighting; if the product is damaged because not properly maintained as set forth in the instruction manual.

D. This is not a service contract, and this warranty does not include maintenance, cleaning or periodic check-up nor do we guarantee as part of this warranty any lumen performance during period. Parts not covered by this warranty include: fuses, external power supplies, third party items not manufactured by Acclaim Lighting. During the period specified above, Acclaim Lighting will replace defective parts at its expense, and will absorb all expenses for warranty service and repair labor by reason of defects in material or workmanship. The sole responsibility of Acclaim Lighting under this warranty shall be limited to the repair of the product, or replacement thereof, including parts, at the sole discretion of Acclaim Lighting. At no time will installation or re-installation or products labor or liability costs will be assumed by Acclaim Lighting. All products covered by this warranty were manufactured after January 1, 2012, and bear identifying serial number marks to that effect.

E. Acclaim Lighting reserves the right to make changes in design and/or improvements upon its products without any obligation to include these changes in any products theretofore manufactured. No warranty, whether expressed or implied, is given or made with respect to any accessory supplied with products describe above. Except to the extent prohibited by applicable law, all implied warranties made by Acclaim Lighting in connection with this product, including warranties of merchantability or fitness, are limited in duration to the warranty period set forth above. And no warranties, whether expressed or implied, including warranties of merchantability or fitness, shall apply to this product after said period has expired.

F. Marine or extreme weather location applications using Acclaim lighting products are subject to a 2 year limited warranty and Acclaim must be notified prior to delivery of units for such applications so that preventative treatment can be made to the products to ensure proper performance and product life with a special marine code coating / sealing process at an additional cost.

G. The consumer's and or dealer's sole remedy shall be such repair or replacement as is expressly provide above; and under no circumstances shall Acclaim Lighting be liable for any loss or damage, direct or consequential, arising out of the use of, or inability to use, this product. This warranty is the only written warranty applicable to Acclaim Lighting products and supersedes all prior warranties and written descriptions of warranty terms and conditions heretofore published.

