

PROJECT

FIRM

ORDER #

TYPE

QTY

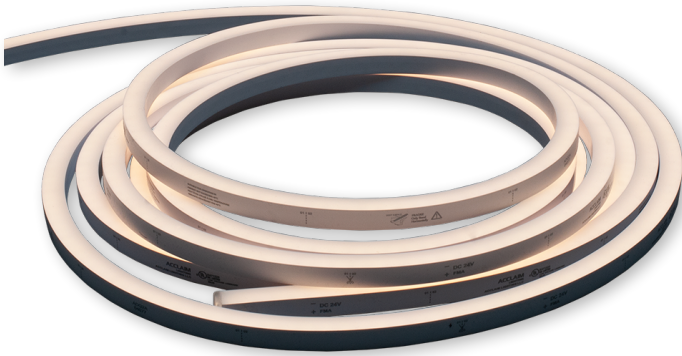

**Flex Tube Mini™** is a ultra low profile, exterior-rated linear LED strip with a fully homogenized 'dotless' direct view appearance. The highly durable silicone body is fully rated to IP67 for wet location use; IK08 for impact resistance and 3G (ANSI C136.31) for high vibration and bridge applications. Two bend-direction options are available, together with a wide range of white color temperatures and saturated colors. Matching aluminum channels perfectly compliment Flex Tube Mini for surface mount, recessed and flexible installations. A range of driver options are available to allow control via DMX, 0-10V or DALI. Alternatively, Flex Tube Mini runs can also be integrated directly into mains-level dimming systems using our reverse/forward phase MLE dimmer drivers.

## At a glance

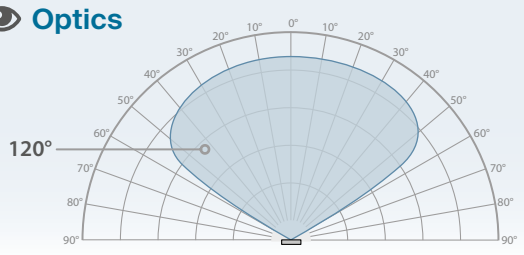

**Optics**



**Emitters**

or or or or or or or or or or or or or or

2200K 2700K 3000K 3500K 4000K 5700K RED GREEN BLUE AMBER





**Power**

Low voltage:  
**24VDC**  
via driver

**Consumption**

**1.37W** per foot  
**4.5W** per meter

**Temperature**

**-40° F** to **131° F**  
**-40° C** to **55° C**

**Output**

Up to  
**102 lumens**  
per linear foot

**Protection**

Ingress: **IP67**  
Impact: **IK08**  
Vibration: **3G**

## Configure your product

**FM -22 -Xnn A N**

Example final code: **FMA-225-X126AEN**

**Bending:**  
**A** = Horizontal  
**B** = Vertical  
*See page 6 for details*

**Feed entry:**  
**2** = Side feed right  
**4** = Side feed left  
**5** = Rear feed  
**6** = End feed

**Length:**  
Please see below

**Emitters:**  
**B** = 2200K  
**D** = 2700K  
**E** = 3000K  
**F** = 3500K  
**G** = 4000K  
**J** = 5700K  
**M** = Red  
**N** = Green  
**O** = Blue  
**P** = Amber



Please specify the required length by quoting the number of 3.28" (83.34mm) sections as a two- or three- figure number between 02 and 180 (equating to lengths between 6.57" (167mm) and 49.2' (15m)). The two- or three- figure number should immediately follow the 'X'. For example, for a 10m length (with horizontal bend, rear feed and 3000K emitters) the order code would be:

**FXA-225-X120AEN**

PROJECT



FIRM

ORDER #

TYPE

QTY

## Specifications

Emitters	2200K, 2700K, 3000K, 3500K, 4000K, 5700K, Red, Green, Blue or Amber
Optics	120°
Output	Up to 102 lumens per foot
Lumen maintenance	L <sub>70</sub> 50,000 hours (@ 25° C)
Control	Low voltage control via optional AL Driver: DMX (0-100%), DALI (0-100%) or 0-10V (1-100%) Mains-level control via optional MLE driver: TRIAC (forward phase) or ELV (reverse phase) - (1-100%)
Operating voltage	24VDC
Power consumption	1.37W per foot (4.5W per meter)
Connection	16.4' (5m) injection molded feed cable with bare tails
Fixture lengths	Built to order lengths up to 49.2' (15m)
Minimum bends	Separate model options with vertical or horizontal bend. Minimum bend radius: 3.93" (100mm)
Mounting	Press-fit aluminum channels in various lengths: 0.78" (20mm), 3.28' (1m) or 6.5' (2m)
Material	UV resistant silicone
Finish	White
Ambient temperature range	-40° F to 131° F (-40° C to 55° C)
Ingress protection	IP67, wet location
Impact protection	IK08, protection against 5 joule impact (30cm distance)
Vibration protection	ANSI C136.31, 3G-rated for high vibration and bridge applications
Warranty	5 years, limited
Weight	4.3 lbs (1.95 kg) for 15m spool
Dimensions	See page 7
Certifications	  

## Photometrics (estimated)

For all available IES files, please visit [acclaimlighting.com/flex-tube-mini](https://acclaimlighting.com/flex-tube-mini)

Color temp. / color	Lumens (/ft)	Max Candela	CRI	TM30
2200K	81.6	26.5	84.2	86.2
2700K	102	32.5	83.6	85.6
3000K	100	31.9	84.2	85.8
4000K	100	31.9	84.2	85.8
Red	33.7	10.8	-	-
Green	115	36.6	-	-
Blue	22.5	7.06	-	-
Amber	38.1	12.2	-	-

PROJECT

FIRM

ORDER #

TYPE

QTY

Related components *(channel dimensions on page 8)*

Rigid channel

A rigid aluminum channel for straight Flex Tube runs. Available in 0.78" (20mm), 3.28' (1m) and 6.56' (2m) lengths. Supplied with between 1 and 10 screws, depending on the chosen length.

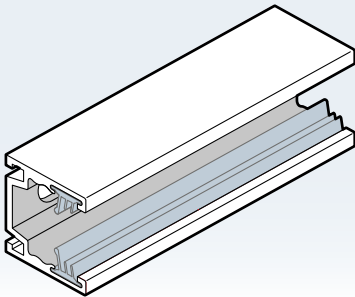

0.78" (20mm) .....	FMCH20
3.28' (1m).....	FMCH1000
6.56' (2m).....	FMCH2000

Rigid flanged channel

A rigid aluminum channel for straight Flex Tube runs, featuring a flanged edge for recessed applications. Available in 0.78" (20mm), 3.28' (1m) and 6.56' (2m) lengths. Supplied with between 1 and 10 screws, depending on the chosen length.

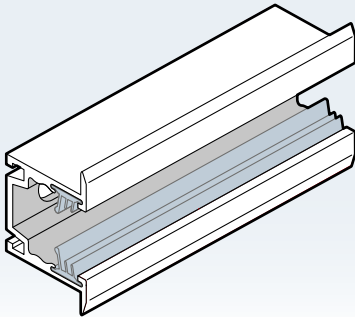

0.78" (20mm) .....	FMRCH20
3.28' (1m).....	FMRCH1000
6.56' (2m).....	FMRCH2000

Flexible channel for horizontal bends

An aluminum channel with one sectioned side wall to allow bends to be formed in the horizontal axis. Available in 1.64' (500mm) and 3.28' (1m) lengths. Supplied with 2 or 5 screws, depending on the chosen length.

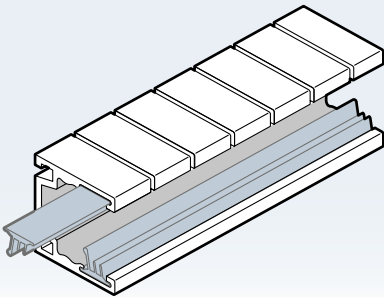

For horizontal bend versions

1.64' (500mm).....	FMFCH500
3.28' (1m).....	FMFCH1000



PROJECT

FIRM

ORDER #

TYPE

QTY

## Related components

### Drivers

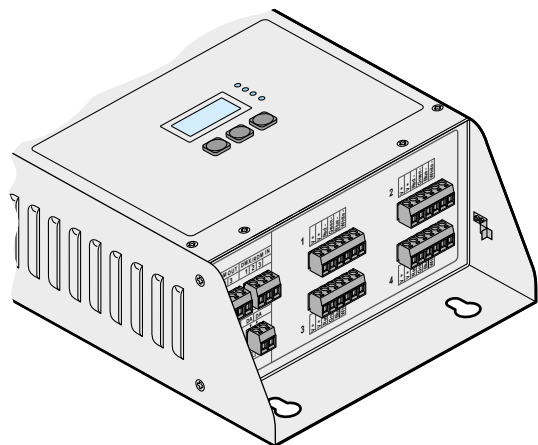

#### AL Driver 200 C2

200W 24VDC  
4 output ports  
**2x 15m spools** maximum  
DMX, DALI or 0-10V  
(sink or source)  
Class 2 compliant  
100-277VAC 50/60Hz  
Part # **ALD-200-24 C2**

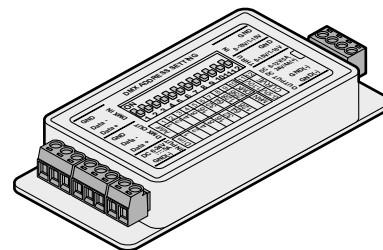

#### AL Driver 1

**1x 15m spool**  
maximum  
DMX or 0-10V  
(sink or source)  
24VDC input (use  
in conjunction with  
ALPS-series 24VDC  
power supplies)  
Part # **ALD001**

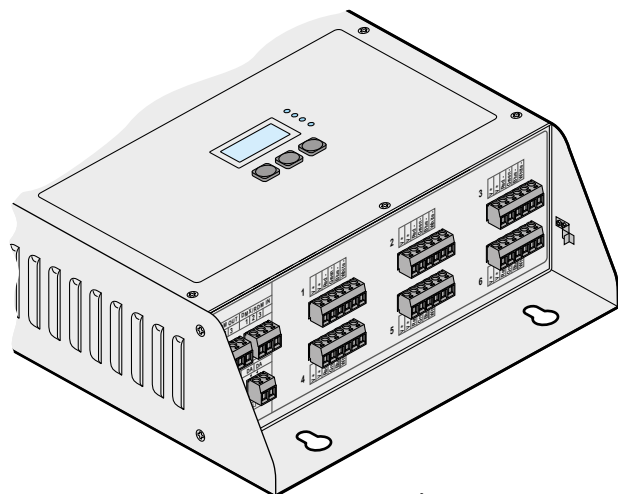

#### AL Driver 400 C2

400W 24VDC  
6 output ports  
**5x 15m spools** maximum  
DMX, DALI or 0-10V  
(sink or source)  
Class 2 compliant  
100-277VAC 50/60Hz  
Part # **ALD-400-24 C2**

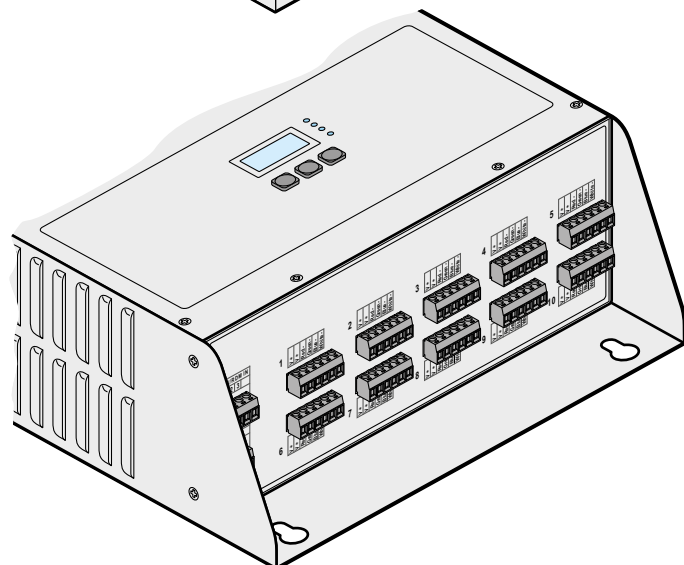

#### AL Driver 800 C2

800W 24VDC  
10 output ports  
**10x 15m spools** maximum  
DMX, DALI or 0-10V  
(sink or source)  
Class 2 compliant  
100-277VAC 50/60Hz  
Part # **ALD-800-24 C2**

SCAN  
FOR  
PRODUCT  
PAGE



PROJECT

FIRM

ORDER #

TYPE

QTY

## Related components

### Power supplies (wet and dry locations)

(for use with single channel drivers or non dimming applications)

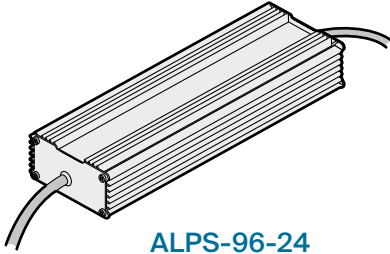

#### ALPS-96-24

96W 24VDC

**1x 15m spool** maximum

IP66 ingress protection

100-277VAC 50/60Hz

Part # **ALPS-96-24**

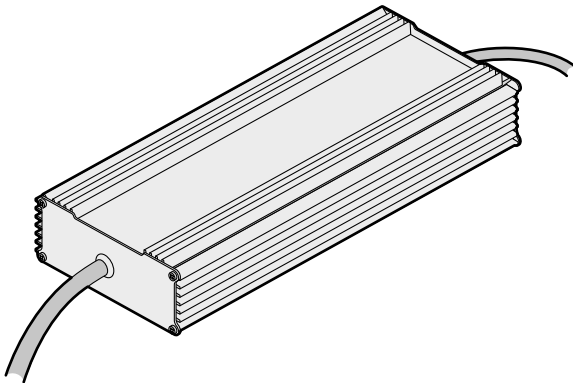

#### ALPS-200-24

200W 24VDC

**2x 15m spools** maximum

IP66 ingress protection

100-277VAC 50/60Hz

Part # **ALPS-200-24**

#### ALPS-400-24

400W 24VDC

**5x 15m spools** maximum

IP66 ingress protection

100-277VAC 50/60Hz

Part # **ALPS-400-24**

### Mains (and 0-10V) dimmable drivers

(to allow Flex Tube SC G2 to be integrated into traditional high voltage dimmer circuits)

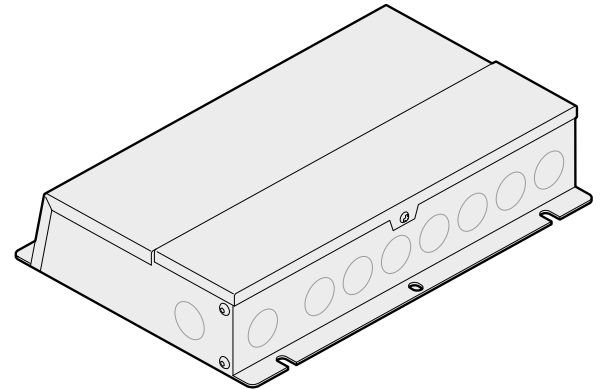

- Can accept dimmed mains from forward phase (leading edge/TRIAC) or reverse phase (trailing edge/ELV) dimmers.
- 100-277VAC input.
- A 0-10V input (sink or source) is also provided for low voltage control when a stable mains supply is used.
- Produces a 1-100% dimming output.
- NEMA 3 enclosure (indoor/outdoor) 100-277VAC 50/60Hz
- Three variants are available:

1x 96W 24VDC

**1x 15m spool** maximum

Part # **MLE96-24DC-UD**

2x 96W (192W total) 24VDC

**2x 15m spools** maximum

Part # **MLE192-24DC-UD**

3x 96W (288W total) 24VDC

**3x 15m spools** maximum

Part # **MLE288-24DC-UD**

SCAN  
FOR  
PRODUCT  
PAGE



PROJECT

FIRM

ORDER #

TYPE

QTY

## Bends and feed entries

Flex Tube Mini strips are available with two bend options and four choices of power feed entries, which can be mixed in any combination to suit your installation.

The bend and feed entry options affect the order code as follows:

**F2#-22#-XA#N**

Bend

Feed entry

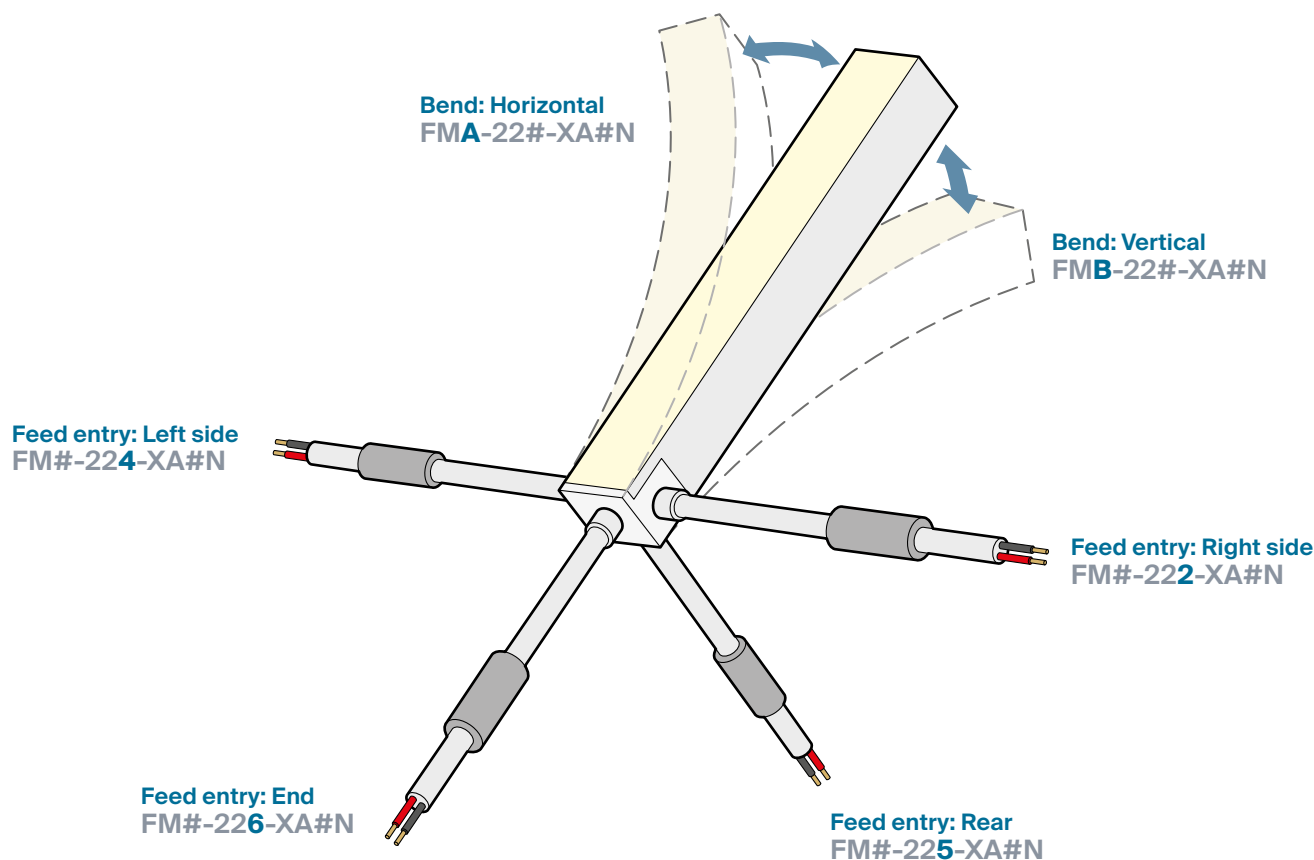

### Link cable guidelines

Connection cable extensions used to link Flex Tubes to the power/driver unit should follow these guidelines:

- Up to 40 feet (12m) 18 AWG (0.823mm<sup>2</sup>)
- Up to 100 feet (30.5m) 14 AWG (2.081mm<sup>2</sup>)
- Up to 170 feet (51.8m) 12 AWG (3.309mm<sup>2</sup>)

In all cases, ensure that the voltage drop at the fixture end of the link cable is no greater than 8% (1.92V) of the original 24VDC supply.



PROJECT

FIRM

ORDER #

TYPE

QTY

## Dimensions

### Rear feed

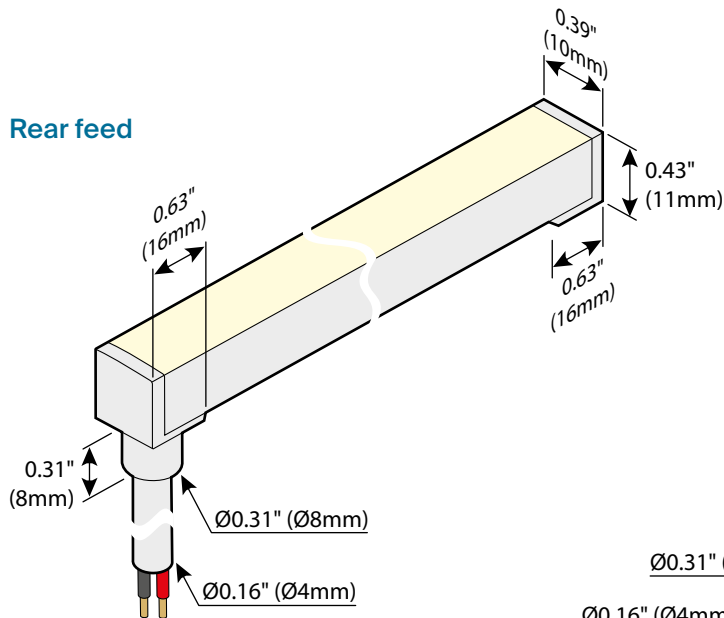

### End feed

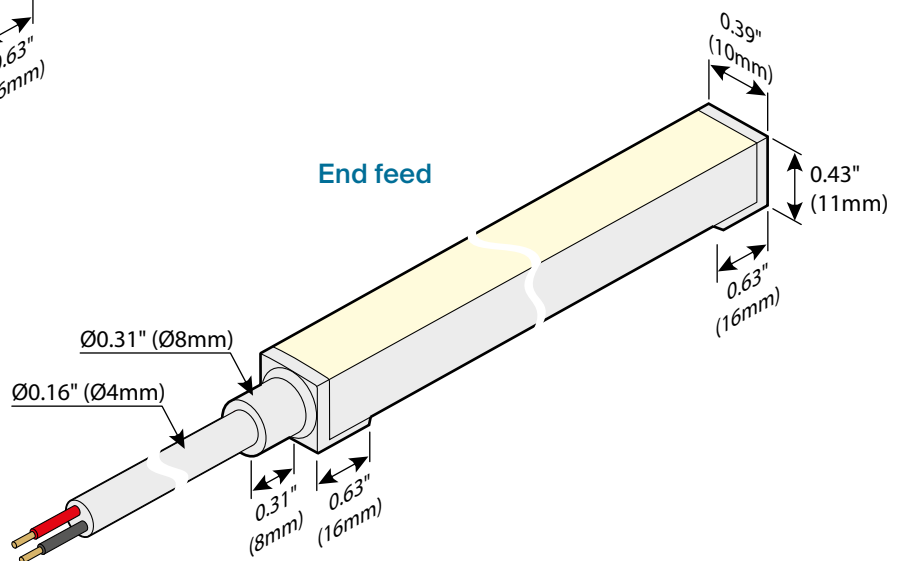

### Side feed

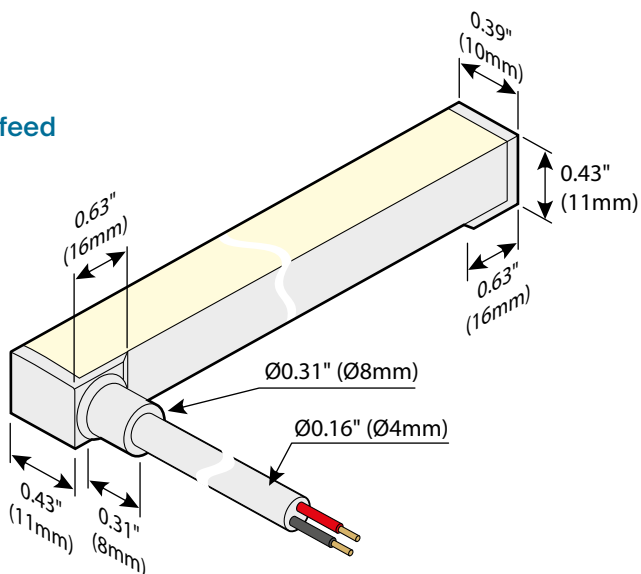

Note: Each feed cable has a metal-encased joint roughly 5" (130mm) from the inlet, which must not be removed.

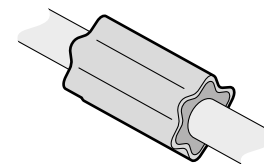

Max  $\text{Ø}0.59"$  (15mm)



PROJECT	FIRM	ORDER #	TYPE	QTY
---------	------	---------	------	-----

## Dimensions

### Rigid channel

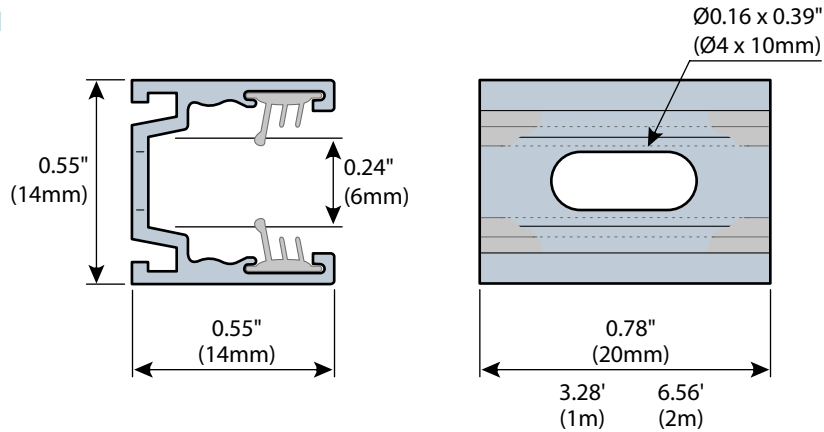

### Rigid flanged channel

