

PROJECT

FIRM

ORDER #

TYPE

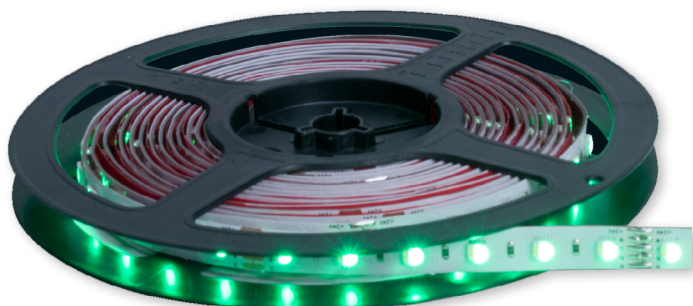

QTY



Flex Spectrum Interior™ is an RGBW flexible strip designed to deliver a wide and accurate gamut in applications where saturated colors, pastels and high-CRI whites are required. By combining blue with the base warm white, it is straightforward to create a wide range of white hues, from 3000K through to 7000K, with CRI values in excess of 80.

Thanks to our careful binning policies, consistent color rendering is assured not only across the full length of every spool, but also between multiple batches. A solid copper substrate ensures optimum heat transference and flexibility. Mounting is greatly aided by 3M™ VHB™ adhesive backing while a full range of aluminum channels are available to suit numerous applications.

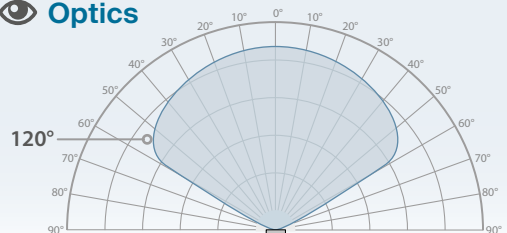
At a glance

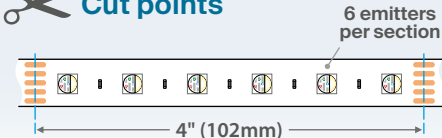
Optics 	Emitters  <p>RGBW (W=3000K)</p>	Mounting  <p>See user guide for mounting details</p>		
Power Low voltage: 24VDC via driver	Temperature 32° F to 104° F 0° C to 40° C	Output Up to 226 lumens per linear foot	Protection Ingress: IP20 Impact: IK00	Cut points 

Order code

FLEXSI



PROJECT



FIRM

ORDER #

TYPE

QTY

Specifications

Emitters	RGBW (W=3000K)
Beam angle	120°
Spool details	16.4' (5m), cut points every 4" (102mm)
Maximum run length	16.4' (5m) - 1 spool
Lumen maintenance	L ₇₀ 50,000 hours (@ 25° C)
Operating voltage	24VDC
Power consumption	5.4W per foot (18W per meter), 90W @ 16.4' (5m) spool
Connection	3.28' (1m) attached feed cable with bare tails (18 AWG)
Mounting	3M™ VHB™ adhesive backing - see user guide for mounting details Optional aluminum channels available - see page 3
Material	Copper strip with white finish
Ambient temperature range	32° F to 104° F (0° C to 40° C)
Ingress protection	IP20, dry location
Impact protection	IK00, not impact protected
Warranty	3 years standard, 5 years optional (additional charge)
Weight	5.18oz (147g)
Dimensions	LxWxH: 16.4' x 0.47" x 0.09" (5000 x 12 x 2.4mm) - see page 7
Certifications	  

Photometrics

For all available IES files, please visit acclaimlighting.com/flex-spectrum-interior

Color	Lumens (per ft)	Center Candela	Efficacy (lumens per Watt)	CRI (Ra)
RGBW	226	73.8	36.87	>80 (white)



PROJECT

FIRM

ORDER #

TYPE

QTY

Related components *(channel dimensions on pages 8 & 9)*

Flex channel low profile

A low profile channel for mounting flat or at an angle using optional brackets. Available in 4' (1.21m) lengths with a choice of clear, frosted or opal lenses.

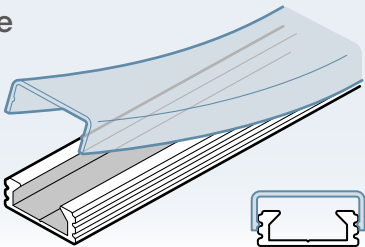

Flex channel low profile:	4' (1.21m)	FLX444
Lenses:	Clear 4' (1.21m).....	FLX LP CL4
	Frosted 4' (1.21m).....	FLX LP FL4
	Opal 4' (1.21m).....	FLX LP OL4
Accessories:	Mount clip/joiner.....	FLX111
	Angled brackets (x2).....	FLX113
	End cap	FCLPEC1

Flex channel tall profile

A tall-sided channel to limit light spill. Mounting can be flat or set at an angle using optional brackets. Available in 4' (1.21m) lengths with a choice of clear, frosted or opal lenses.

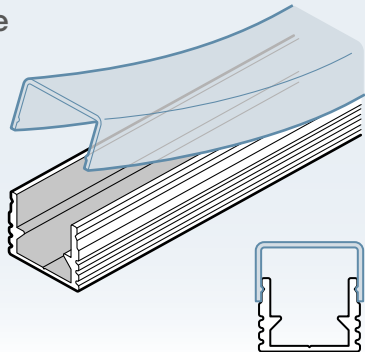

Flex channel tall profile:	4' (1.21m)	FLX888
Lenses:	Clear 4' (1.21m).....	FLX825
	Frosted 4' (1.21m).....	FLX813
	Opal 4' (1.21m).....	FLX801
Accessories:	Mount clip/joiner.....	FLX111
	Angled brackets (x2).....	FLX113

Flex channel recessed

A flanged deep channel to provide a neat finish when recessed within a surface. Available in 4' (1.21m) lengths with a choice of clear, frosted or opal lenses.

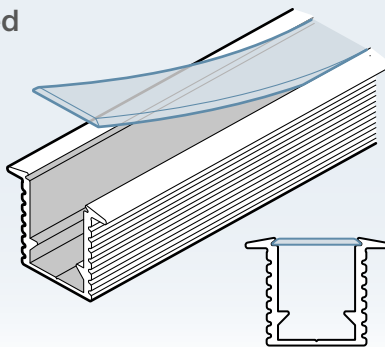

Flex channel recessed:	4' (1.21m)	FLX777
Lenses:	Clear 4' (1.21m).....	FLX727
	Frosted 4' (1.21m).....	FLX715
	Opal 4' (1.21m).....	FLX702
Accessories:	Mount clip/joiner.....	FLX111
	End cap	FCTPEC1



PROJECT

FIRM

ORDER #

TYPE

QTY

Related components *(channel dimensions on pages 8 & 9)*

Flex dual channel

A box section channel with detachable back plate to allow invisible fixing to wall surfaces. The upper and lower surfaces of the main channel can hold up to four runs of strips to provide powerful simultaneous up and down lighting (or side to side when the channel is mounted vertically). Available in 3.28' (1m) lengths.

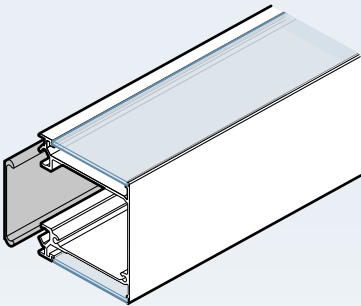

Flex dual channel:	3.28' (1m)	FLK DUL
Lenses:	Clear 3.28' (1m).....	FLK DUL CL
	Frosted 3.28' (1m).....	FLK DUL FL
Accessories:	End cap	FLK DUL EC

Flex drywall channel

An adaptable system of channels for use with drywall interiors in either recessed or surface mount configurations. Available in 3.28' (1m) lengths with a choice of clear or frosted lenses.

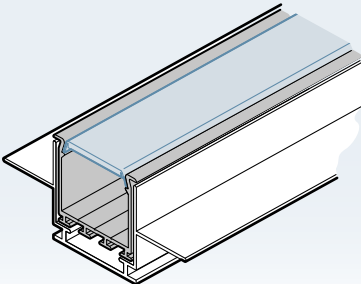

Drywall mount:	3.28' (1m)	FLK DWM
Channel:	3.28' (1m)	FLK DWC
Channel with flange:	3.28' (1m)	FLK DWF
Lenses:	Clear 3.28' (1m).....	FLK DCL
	Frosted 3.28' (1m).....	FLK DFL
Accessories:	Mount end cap	FLK DWM EC
	Channel end cap	FLK DWC EC
	Surface spring	FLK DWC SS
	Mounting clip.....	FLK DWM CLIP



PROJECT

FIRM

ORDER #

TYPE

QTY

Related components

Drivers

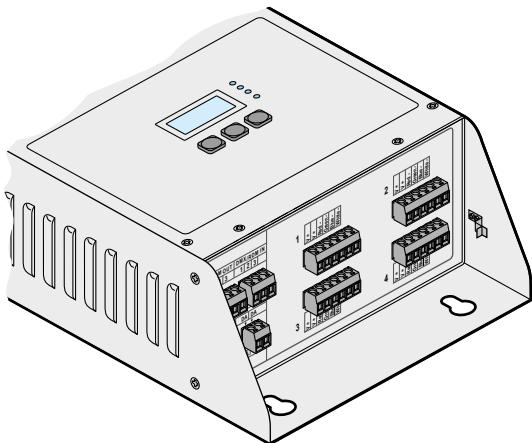

AL Driver 200 C2

200W 24VDC
4 output ports
2 spools maximum
DMX, DALI or 0-10V
(sink or source)
Class 2 compliant
100-277VAC 50/60Hz
Part # **ALD-200-24 C2**

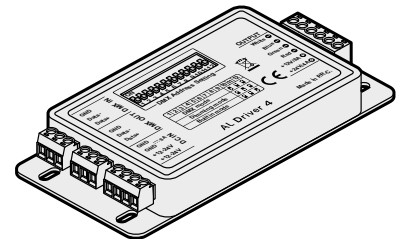

AL Driver 4

1 spool maximum
DMX or 0-10V
(sink or source)
24VDC input (use
in conjunction with
ALPS-series 24VDC
power supplies)
Part # **ALD004**

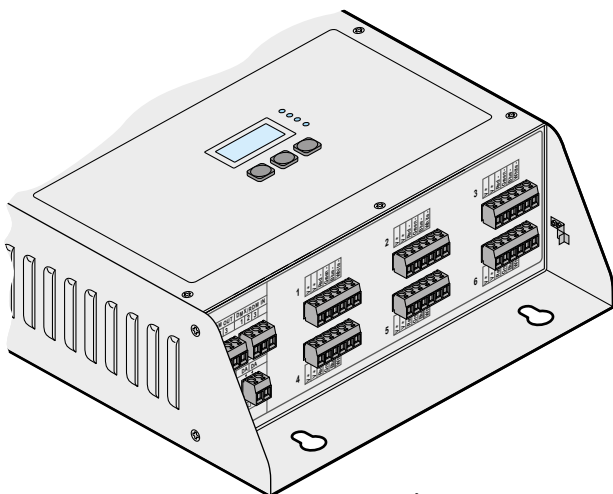

AL Driver 400 C2

400W 24VDC
6 output ports
4 spools maximum
DMX, DALI or 0-10V
(sink or source)
Class 2 compliant
100-277VAC 50/60Hz
Part # **ALD-400-24 C2**

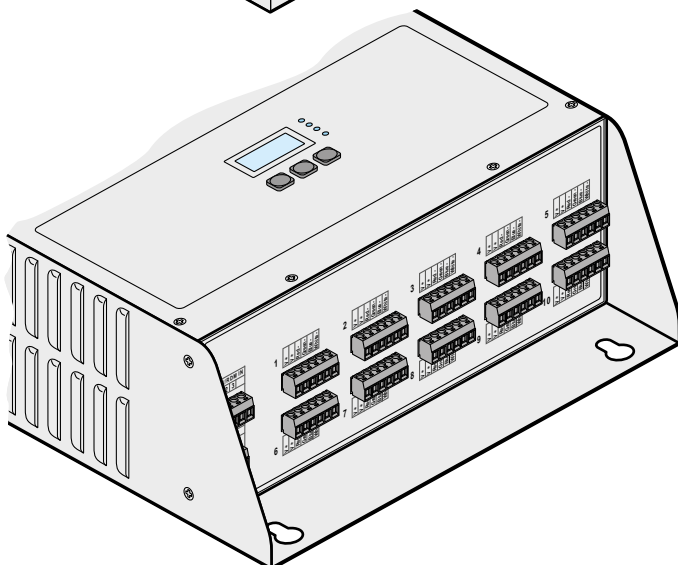

AL Driver 800 C2

800W 24VDC
10 output ports
8 spools maximum
DMX, DALI or 0-10V
(sink or source)
Class 2 compliant
100-277VAC 50/60Hz
Part # **ALD-800-24 C2**



PROJECT

FIRM

ORDER #

TYPE

QTY

Related components

Power supplies (wet and dry locations)

(for use with AL Driver 4)

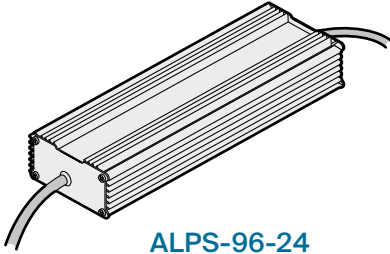

ALPS-96-24

96W 24VDC

1 spool maximum

IP66 ingress protection

100-277VAC 50/60Hz

Part # **ALPS-96-24**

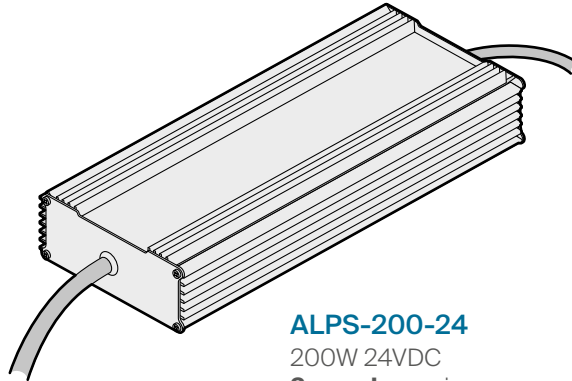

ALPS-200-24

200W 24VDC

2 spools maximum

IP66 ingress protection

100-277VAC 50/60Hz

Part # **ALPS-200-24**

ALPS-400-24

400W 24VDC

4 spools maximum

IP66 ingress protection

100-277VAC 50/60Hz

Part # **ALPS-400-24**



SCAN
FOR
PRODUCT
PAGE

PROJECT

FIRM

ORDER #

TYPE

QTY

Dimensions *(Strip)*

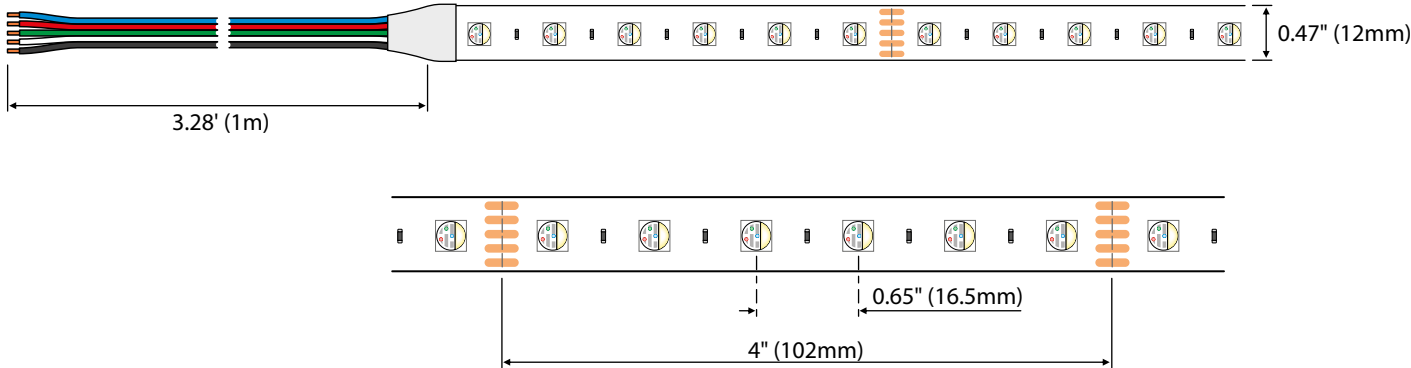

Feed wire guide *(90W load / 1 spool)*

Maximum distance to Flex Spectrum strip	Required wire gauge
40' (12m)	18 AWG (0.823mm²)
100' (30.5m)	14 AWG (2.081mm²)
180' (55m)	12 AWG (3.309mm²)

In all cases, ensure that the voltage drop at the fixture end of the link cable is no greater than 8% (1.92V) of the original 24VDC supply.



PROJECT

FIRM

ORDER #

TYPE

QTY

Dimensions *(Channels)*

Flex channel low profile

FLX444

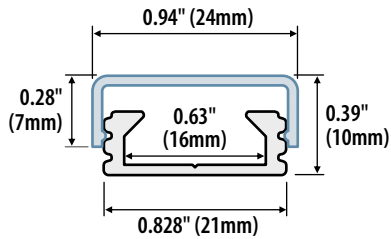

Flex channel tall profile

FLX888

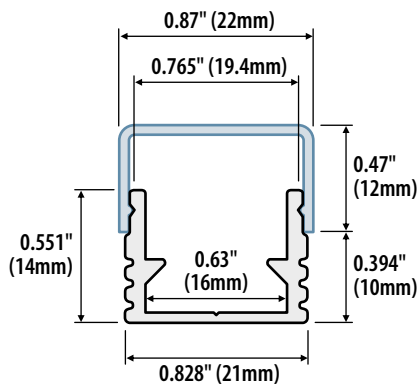

Flex channel recessed

FLX777

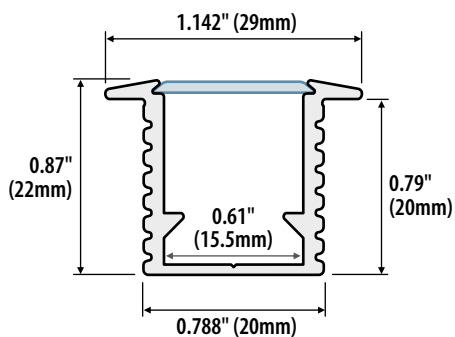

Flex dual channel

FLX DUL

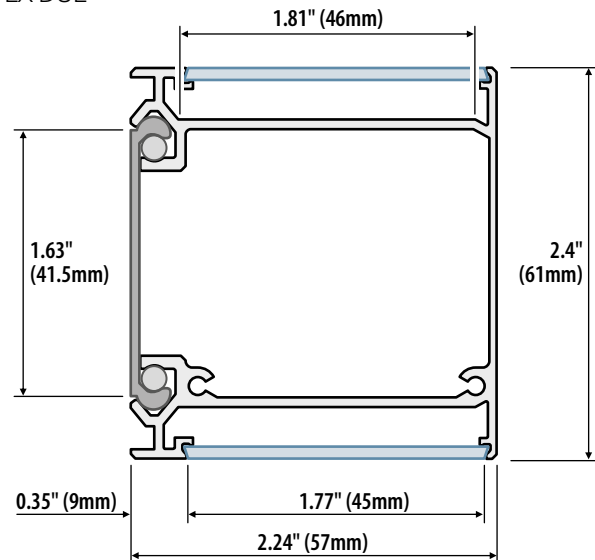

PROJECT

FIRM

ORDER #

TYPE

QTY

Dimensions *(Channels)*

Flex drywall channel components

FLX DWM (Drywall mount)

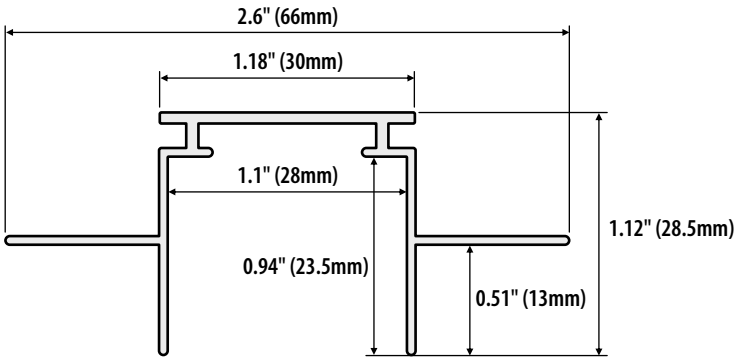

FLX DWC (Drywall channel)

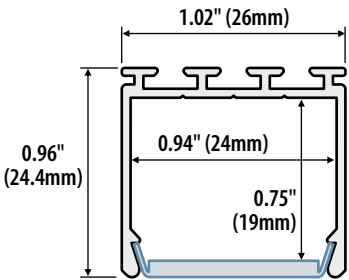

FLX DWF (Drywall channel with flange)

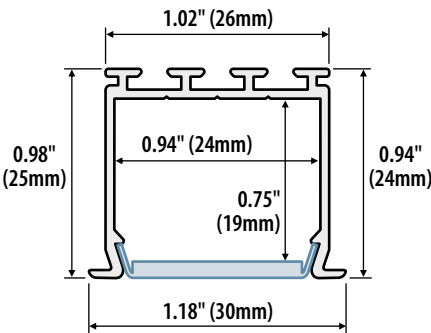

For full installation details, please refer to the **user guide**, available for free download here:

