

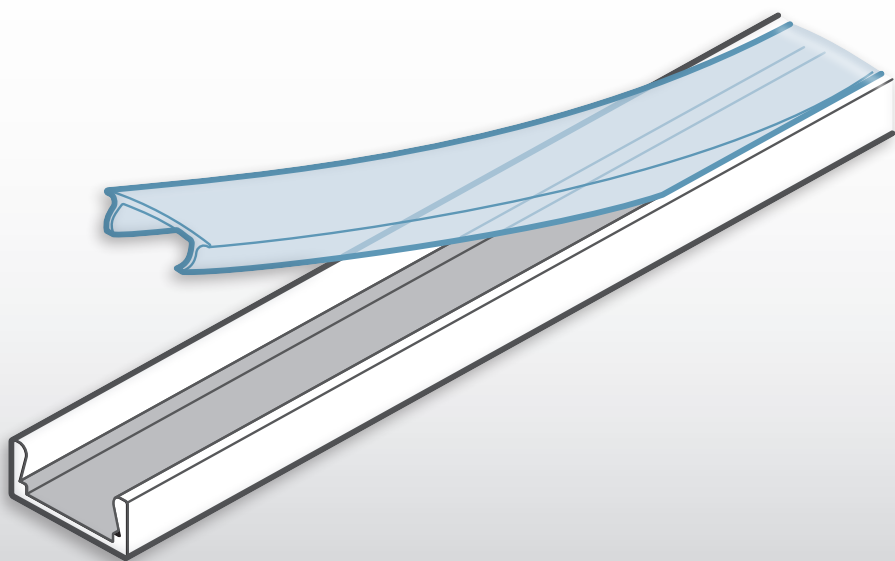

Acclaim™



Flex Mini Channel

User guide

Installation

Mounting

Flex Interior tapes are supplied with 3M™ VHB acrylic adhesive backing, protected by a peel-off paper liner. To ensure that good adhesion is achieved, ensure the mounting surface is free of grease, moisture and any contaminates.

When mounting on the sides or undersides of surfaces

We recommend that you add small dots of silicone sealant along both sides of the Flex tape (to overlap the tape edge and mounting surface) using Dow Corning® 799, 1199 or equivalent. This will provide additional stability and help to prevent any separation of the tape from the mounting surface over time. The silicone dots are best applied once the tape is fixed in place; then the whole installation should not be disturbed until it the sealant has fully cured.

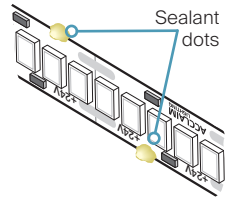

Cleaning and preparing the mounting surface

Most substrates are best prepared by cleaning with a 50:50 mixture of isopropyl alcohol (IPA) and water* prior to applying the tape. Exceptions to this general procedure that may require additional surface preparation include:

Heavy oils

A degreaser or solvent-based cleaner* (such as 3M™ Prep Solvent 70, 3M™ Citrus Base Cleaner, mineral spirits, naphtha or similar, subject to suitability for the surface material) may be required to remove heavy oil or grease from a surface and should be followed by cleaning with IPA/water*.

Other contamination or oxidation

Abrading a surface, followed by cleaning with IPA/water*, can remove heavy dirt or oxidation (e.g. galvanized steel) and can increase surface area to improve adhesion. Abrasion often also helps adhesion to paints and plastics. Very small scratches in the surface, generated with circular motion rather than straight-line motion, are most desirable.

** Note: These cleaner solutions contain greater than 250 g/l of volatile organic compounds (VOC). Please consult your local Air Quality Regulations to be sure the cleaner is compliant. When using solvents, be sure to follow the manufacturer's precautions and directions for use when handling such materials.*

Flex mini channel (FLX MIN)

The Flex mini channel is a very low profile channel with minimal standoff from the mounting surface. A choice of three lenses provide varying light distributions while mounting is best handled using the steel mounting bracket options.

Options

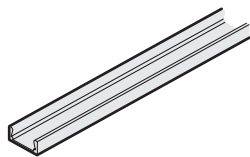

Flex mini channel
(3.28'/1m or 6.56'/2m)
[FLX MIN ##]

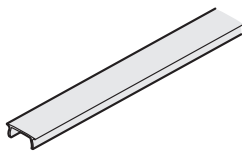

Lenses (3.28'/1m or 6.56'/2m)
[Clear: FLX MIN CL ##]
[Frosted: FLX MIN FL ##]
[Opal: FLX MIN OL ##]



Mount clip
[FLX MIN MC]



Solid end cap
[FLX MIN EC]



End cap with hole
[FLX MIN ECH]

To fit the Flex tape

- 1 If necessary, cut the channel (remember to leave space for the end caps) to the length required. Ensure that any resulting burrs are removed.
- 2 Ensure the tape mounting surface within the channel is completely dry, clean and free of grease.
- 3 Determine the length of tape required. Leave at least a 5mm gap at each end to allow the end caps to be inserted. Mark the positions at each end of the channel where the tape will be placed.

Note: Flex tape can be cut only at certain points, which may slightly constrain the precise lengths of tape that can be achieved. Therefore it may be beneficial to center the tape within the channel to achieve an even distribution. If the section of Flex tape you are using requires feed cables to be attached, it will be necessary to solder new connections as the Flex mini channel is too small to accommodate feed or link connectors. You will find it easier to solder the connections before fitting the tape into the Flex mini channel.

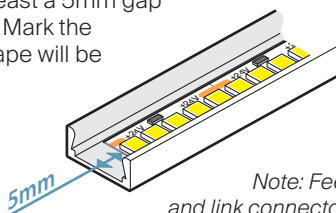

Note: Feed and link connectors cannot be fitted inside this channel.

- 4 Cut the tape to the nearest marked cutpoint.
- 5 Begin peeling the backing from the Flex tape and carefully stick the Flex tape into the channel, starting at the marked position.

IMPORTANT: While pressing the Flex tape into position, take care not to put excessive pressure on the components or connections.

To mount the channel

- 1 If necessary, carefully solder to the contact pads.
- 2 Fit the Flex tape to the channel (see page 2).
- 3 Attach two or more *steel mounting brackets* to the mounting surface using screws appropriate to the surface type.
- 4 Clip or slide the channel into the mounting brackets.

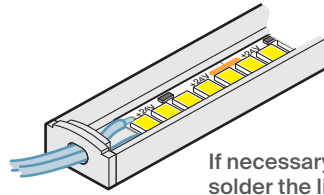

If necessary, solder the link cables to the contact pads

Note: Ensure sufficient strain relief where the cables enter the channel.

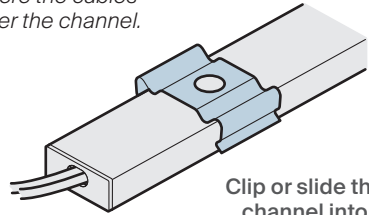

Clip or slide the channel into the mounting brackets

To fit a lens

- 1 Measure the exact length of lens required between the end caps at each end of the channel.
- 2 Carefully cut the lens to length. Ensure that any resulting burrs are removed.
- 3 Insert one end of the lens against one of the end caps so that it locates into the 'Lens recess' within the channel (see right).
- 4 Once the first part of the lens has correctly located, run your thumb gently along the length of the lens to push the remainder into place.

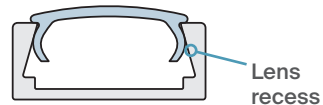

Lens recess

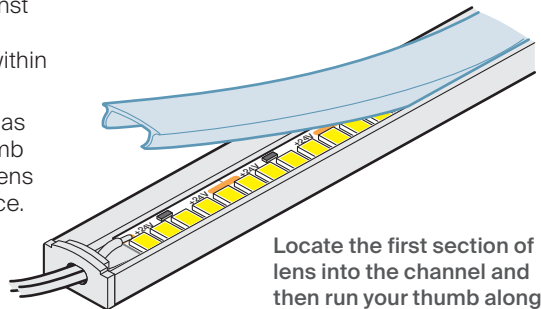

Locate the first section of lens into the channel and then run your thumb along it to push the remainder into place.

Dimensions

