

PROJECT

FIRM

ORDER #





TYPE

QTY

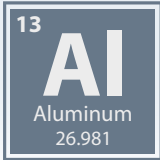

**Flex Graze channel** is a low profile channel that, when used with its rounded lens produces a linear spread of light suitable for grazing nearby surfaces. The supplied mounting rail can be optionally used to alter the distance between the emitters and the lens and thus determine the resulting beam angle (the beam angle is 10° as standard if the mounting rail is not used). The channel and lens are available in 3.28' (1m) lengths.

## At a glance

 <b>Temperature</b>  <b>32° F to 104° F</b> <b>0° C to 40° C</b>	 <b>Protection</b>  <b>IP20</b> <b>Dry location</b>	 <b>Material</b>  	 <b>Compatible with:</b>  <b>Ai Flex Interior</b> <b>Flex Eco Interior</b> <b>Flex One SO Interior</b> <b>Flex One HO Interior</b>
---	--	---	---

## Order code

**FLK GRZ** 3.28' (1m) length (includes an internal mounting rail)

## Dimensions

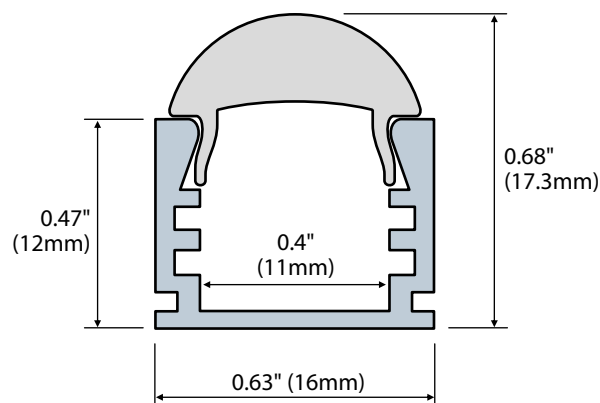

PROJECT

FIRM

ORDER #

TYPE

QTY

Specifications

Length	3.28' (1m), cut to length as required
Material	Double anodized aluminum, optional polycarbonate lenses
Ambient temperature range	32° F to 104° F (0° C to 40° C)
Ingress protection	IP22, dry location
Mounting	Via optional stainless steel mount brackets
Warranty	3 years, limited
Weight	9.52oz (270g) per 3.28' (1m) length

Beam angles

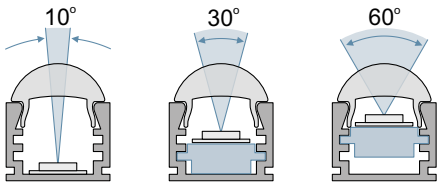

Change the mounting rail position to determine the beam angle.

Related components

Lenses - 3.28' (1m) in length

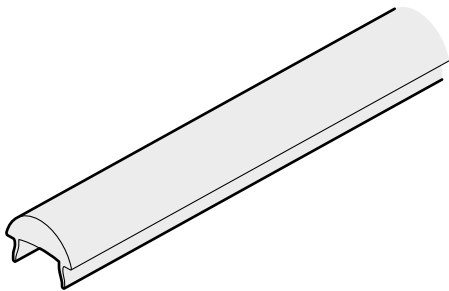

Clear

FLK GRZ L

Mount

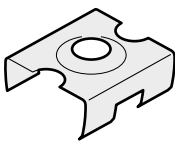

Stainless steel mount clip

FLK SMB

End cap



Solid end cap

FLK GRZ EC

