

Flex Tube SE RGB™

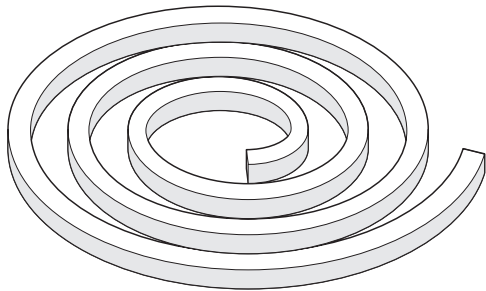

Client:

Project:



Type:

Order Code:

Quantity:

Flex Tube SE RGB is a side emitting, outdoor rated, flexible color changing LED tube. It is available with tri-color RGB LEDs, which cover nearly every possible color combination required. It features an IP68 rating, cut points every 3.28", and a minimum bend radius of 12". Sold in spools of 23' (7m), it is impact, UV, and saltwater resistant.

Specifications

Color	RGB
Spool Length + Cut Points	23' (7m), Cut points every 3.28" (83.3mm)
Beam Angle	160°
Max Fixture Runs	23' (7m) - 1 spool maximum
Photometrics	Photometric testing in progress
Dimming Protocol	via DMX-512, 3 channels per spool / section
Mounting	via Self lock mounting channel
Power Consumption	76W @ 23' (1 Spool), minimum 3.3W per foot
Operating Voltage	24VDC
Lumen Maintenance	L70 @ 50,000 Hours (25° C)
Housing & Finish	White UV stabilized, flexible PVC jacket with silicone top
Installation Temperature	32°F to 113°F (-0°C to 45°C)
Operating Temperature	-40°F to 131°F (-40°C to 55°C)
IP / IK Rating	IP68 - Wet Location / Submersible, IK 08 - Up 5 Joule Impact Energy Protection
Fixture Connectors	10' (3m) Attached injection molded feed cable - rear, side or end feed options (see page 2)
Warranty	3 Years standard, 5 Years optional (additional charge)
Weight	8 lbs (3.62 kg)
Dimensions	W 0.63" x H 0.63" x L 32' (16mm x 16mm x 10m)
Certifications	 

Order Codes

* Indicates Special Order

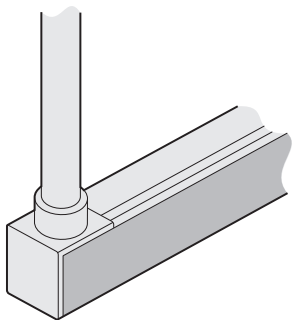
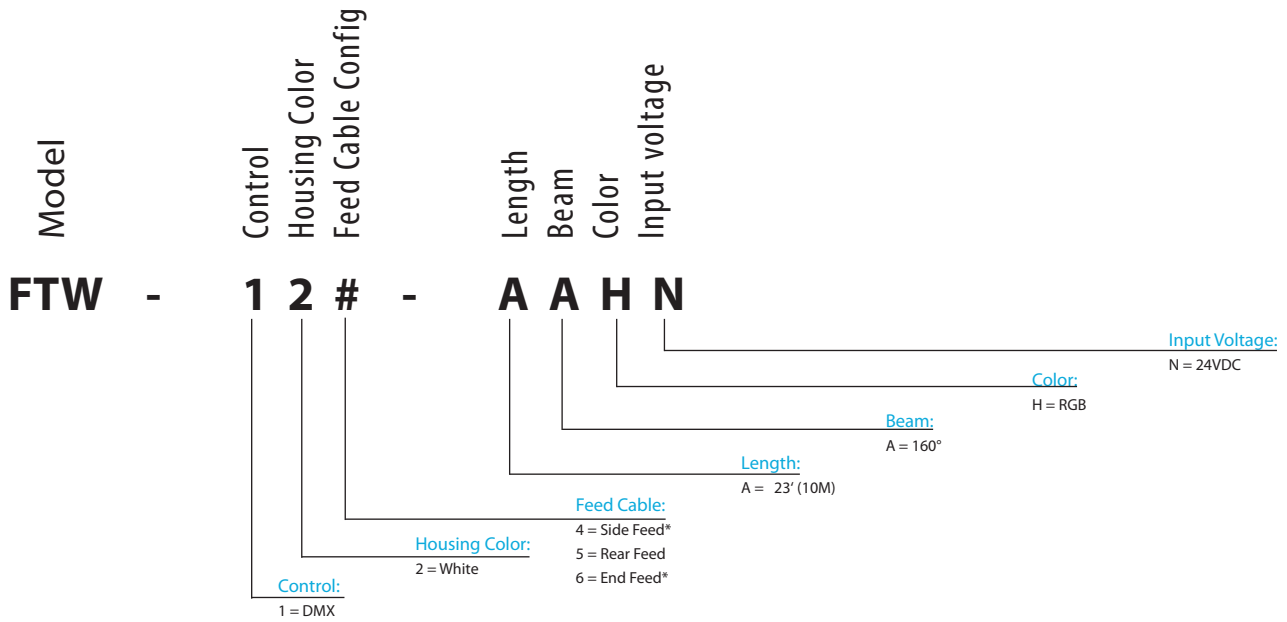

FTW-124-AAHN, Side Feed

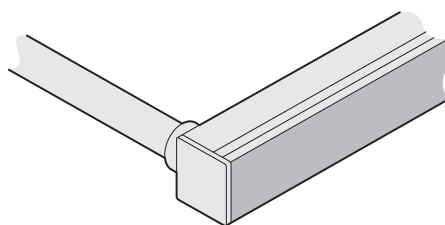

FTW-125-AAHN, Rear Feed

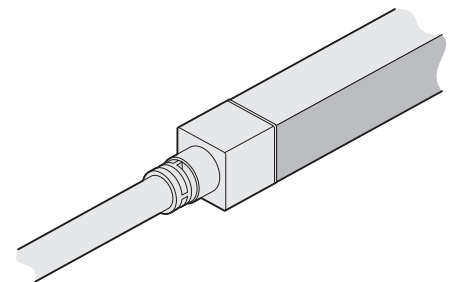

FTW-126-AAHN, End Feed

Related Components

Power Supplies (Use with AL Dimmer 1 Pro)

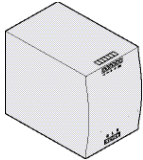

APS-240-24

Two Spools Maximum

240W, 24VDC, Dry location, DIN Rail Mount
115-230VAC (47-63Hz) Input

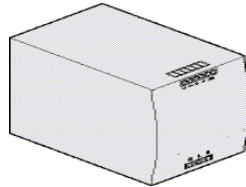

APS-480-24

4 Spools Maximum

480W, 24VDC, Dry location, DIN Rail Mount
115-230VAC (47-63Hz) Input

DMX Drivers

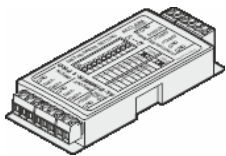

DPW-311-JBAT

AL Dimmer 3 Pro, 1 Spool Max.

Three channel DMX driver
Use in conjunction with APS Series

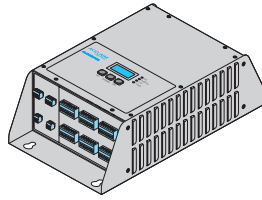

ALD-400-24

AL Driver 400 24V, 3 spools max

400W 24V power supply + DMX,
0-10V (source) & DALI driver
6 output ports, 100-277VAC input

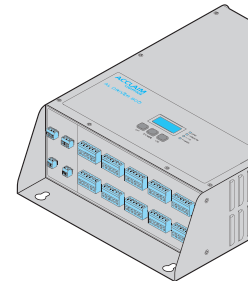

ALD-800-24

AL Driver 800 24V, 8 spools max

800W 24V power supply + DMX,
0-10V (source) & DALI driver
10 output ports, 100-277VAC input

Accessories

*Please note that there are no feed cables for this product. Cut sections cannot be re-used.

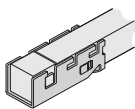

FTSEEC

Flex Tube SE end cap

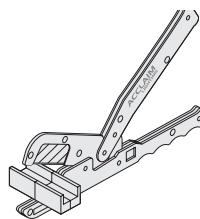

FTTK2

Flex Tube Install Kit

Includes cutter and insert assists

Self Lock Mounting Channels

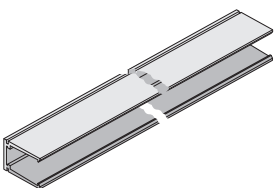

FTSELC1M

Flex Tube SE self lock mounting channel
3.28' (1m)

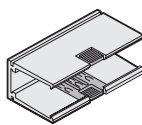

FTSELC5CM

Flex Tube SE self lock mounting channel
2" (5cm)