

Client:

Project:

Type:

Order Code:

Quantity:

Flex Tube Pixel is a flexible, direct view LED strip that features RGB control of every 4.9" (125mm) section. It comes in a 10M spool that can be cut to length to suit project requirements, and features a highly durable PVC body which is outdoor and impact rated.

SPECIFICATIONS

Colors	RGB
Beam Angle	134°
Photometrics	85 lumens per foot (see page 4 for details)
Strip Length	32.8' (10M) field-cutttable spool, or built to order lengths from 4.9" to 32.8'
Control & Channel Count	0-100% dimming via DMX / SPI, 3 channels per 4.9" pixel, 240 channels per 32.8' (10M)
Sections / Pixels	Pixel distance of 4.9" (125mm), 80 RGB sections per 32.8' (10M) spool, 2.4 sections per foot
Power Consumption	3.65W per foot, 12W per meter
Operating Voltage	24VDC
Lumen Maintenance	L70 @ 50,000 hours (25° C)
Mounting	Locking aluminum mounting channel, 1.37" (35mm), 3.28' (1m), or 6.56' (2m) lengths
Finish	White
Material	PVC
Ambient Operating Temperature	-40° F to 122° F (-40° C to 50° C)
IP Rating	IP68, wet location and submersible* (with injection molded ends), IP67 with cut sections
IK Rating	IK08, protection against 5 joule impact
Fixture Connectors	9.84' (3M) injection molded feed cable and end cap included
Warranty	3 Years standard, 5 years optional (with additional charge), limited
Weight	7.6 lbs (3.5 kg) - 10M Spool
Dimensions	L: As specified W: 0.45" H: 0.88" / L: As specified W: 11.5 H: 22.5mm
Certifications	

*UL approval limits submersible installation to non-human occupied and freshwater locations only. All cables must be landed in environmentally suitable junction boxes.

ORDER CODES

* indicates special order

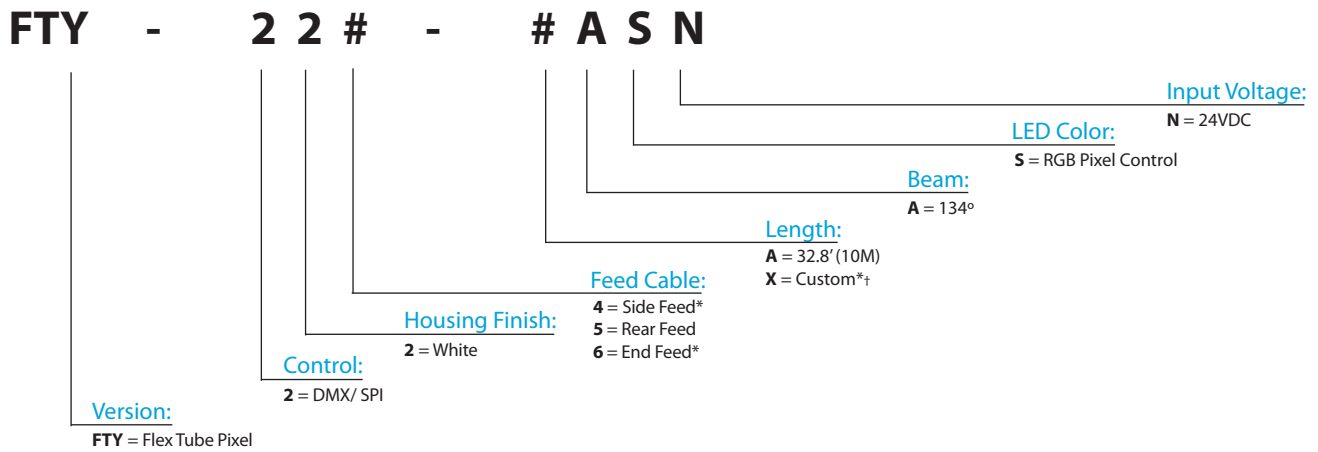

†: When ordering custom lengths, please specify number of 4.9" (125mm) sections required after X (32.8', 10M maximum).
Example order code: **FTY-225-X40ASN = 125mm x 40 / 5m spool**

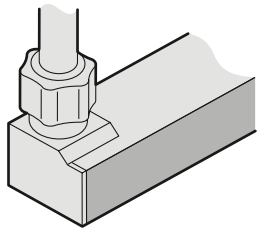

FTY-224-####, Side Feed

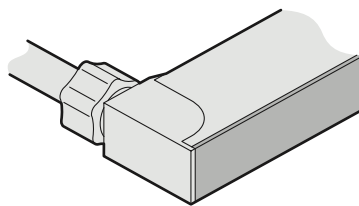

FTY-225-####, Rear Feed

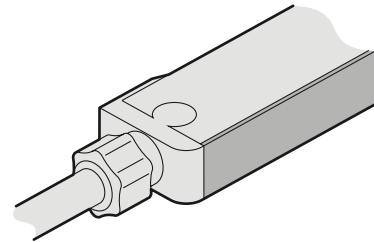

FTY-226-####, End Feed

RELATED COMPONENTS

Mounting Accessories

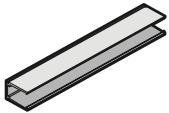

FTCH35

35mm (1.37") self lock mounting channel
Aluminum profile, includes 2 screws

FTCH1000

1M (3.28') self lock mounting channel
Aluminum profile, includes 5 screws

FTCH2000

2M (6.56') self lock mounting channel
Aluminum profile, includes 10 screws

Connection Accessories

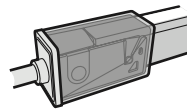

FTPFC

3M (9.84') feed cable + connector for Flex Tube Pixel
IP67 rating, 2nd generation toolless design

FTEC

End cap for top emitting flex tube products
IP67 rating, 2nd generation toolless design

Additional Accessories



FTTK2

Flex Tube Toolkit

One required per project

Drivers (DC+DMX)



PIX001

Pixel Driver 1

12-24VDC Input, DMX input, SPI output
Controls up to one 10M (32.8') section of Flex Tube Pixel
Must be used with 24V power supply

Power Supplies (DC)



APS-300-24-IP

100-277VAC Input, 24VDC Output

Powers up to two 10M (32.8') sections of Flex Tube Pixel
Must be used with Pixel Driver 1

RELATED COMPONENTS

Multiple Zone Controller



LPC

Flexible, multi-location lighting control
5,120 to 51,200 control channels
Program and pixel map via PC or Mac

Single Zone Controller



VLC

Video control for a single array / screen
25,600 to 768,000 control channels
HD video via local media files or DVI-D input

Artnet / sACN to DMX Converter

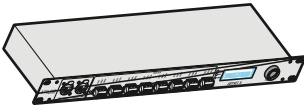

ARTNET 8

8 Universe ArtNet and sACN to DMX converter
100 - 240VAC input

PHOTOMETRICS

Color	Lumens (per foot)	Max Candela	CRI	Lumens per Watt
RGB	85.4	23.9	N/A	15

DIMENSIONS (in mm)

Rear Feed (FTY-125)

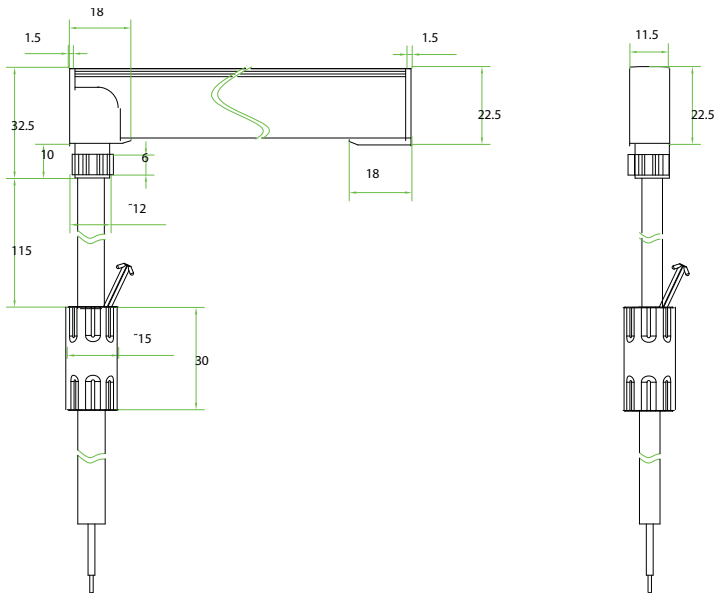

Side Feed (FTY-124)

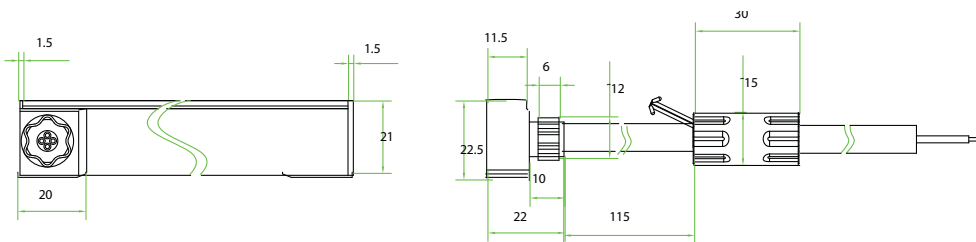

End Feed (FTY-126)

